

"A06GF" SERIES COSTECH FANS

Description: a.c. axial fan 60x60x30 mm

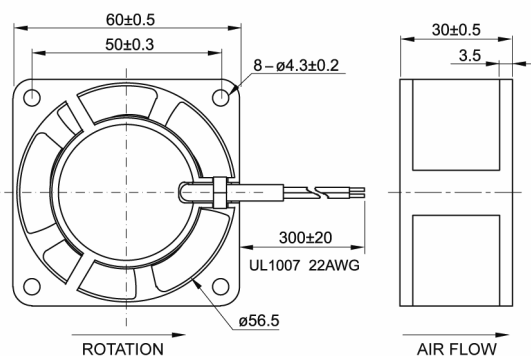

Casing material:	Black varnished aluminum
Impeller material	Black fibreglass reinforced plastic (PBT PC) UL 94V-0
Protection degree:	IP20, according to EN 60529 standard
Fixing system:	by No 4 M4 screws
Motor protection:	Impedance
Storage temperature:	from -40°C to +80°C
Rated temperature range:	from -40°C to +70°C
Lifetime L10 at 40°C:	40,000 h
Electrical connection:	2 leads 22AWG UL 1007, 300 mm long.
Weight:	0.14 kg
Approvals:	UL E223195

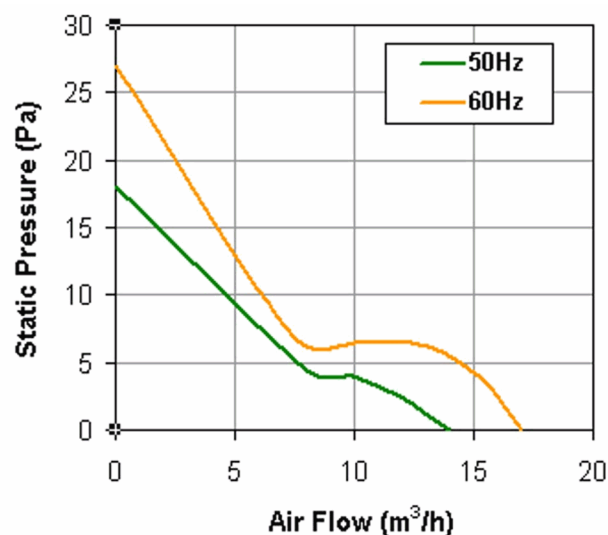

Model	Bearing	Voltage	Frequency	Rated Current	Rated Power	Max Air Flow**	Static Pressure	Noise	RPM	Approvals
		(V)	(Hz)	(A)	(W)	(m3/h)	(Pa)	[db(A)]	(rpm)	
A06G12HWBF00	Ball	115 V a.c.	50/60	0.042/0.035	5.0/4.0	14/17	18/27	27.0/28.0	2,200/2,800	CE; cURus
A06G23HWBF00	Ball	230 V a.c.	50/60	0.025/0.021	5.0/4.0	14/17	17/27	27.0/28.0	2,400/3,000	CE; cURus

"A08AF" SERIES COSTECH FANS

Description: **Axial fan a.c. 80x80x25mm**

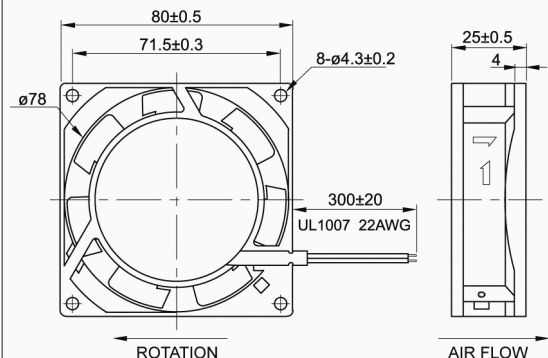

Casing material:	aluminium die casting alloy ADC-12
Impeller material	black fibreglass reinforced plastic (PBT) UL 94V-0
Protection degree:	IP44, according to EN 60529 standard
Fixing system:	4 holes Ø4.3 mm
Motor protection:	impedance
Storage temperature:	from -40°C to +80°C
Rated temperature range:	from -40°C to +70°C
Lifetime L10 at 40°C:	40,000 h ball bearing 15,000 h sleeve bearing
Electrical connection:	2 leads 22AWG UL 1007, 300 mm long
Weight:	0.26 kg
Approvals:	CE; UL E223195

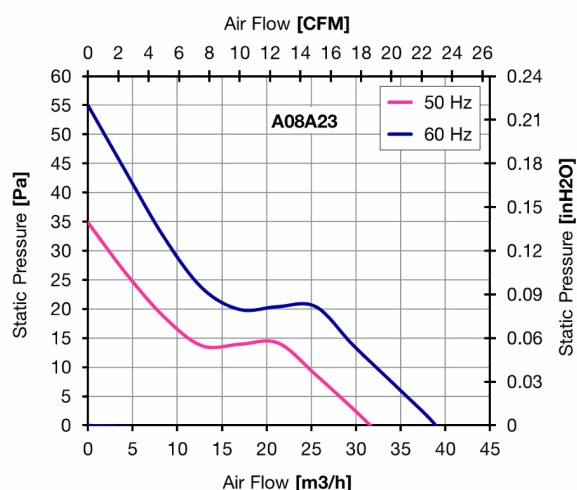
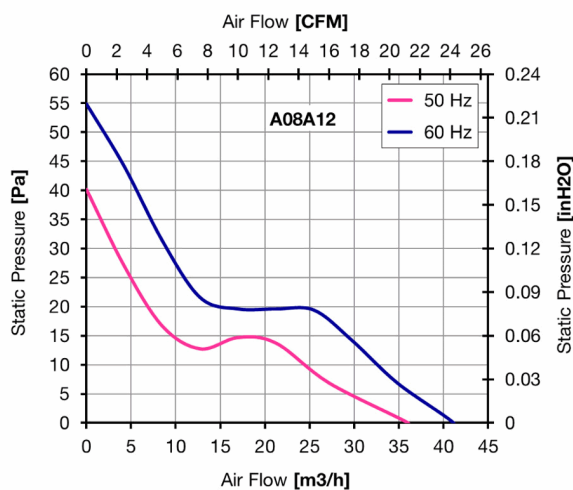

Model	Bearing	Voltage	Frequency	Rated Current	Rated Power	Max Air Flow**	Static Pressure	Noise	RPM	Approvals
		(V)	(Hz)	(A)	(W)	(m3/h)	(Pa)	[db(A)]	(rpm)	
A08A12HWBF00	Ball	115 V a.c.	50/60	0.150/0.120	14/11	36/41	40/55	32.0/35.0	2,600/3,100	CE; cURus
A08A12HWSF00	Sleeve	115 V a.c.	50/60	0.150/0.120	14/11	36/41	40/55	32.0/35.0	2,600/3,100	CE; cURus
A08A23HWBF00	Ball	230 V a.c.	50/60	0.080/0.070	16/14	32/39	35/55	32.0/35.0	2,600/3,100	CE; UR
A08A23HWSF00	Sleeve	230 V a.c.	50/60	0.080/0.070	16/14	32/39	35/55	32.0/35.0	2,600/3,100	CE; UR

"A08BF" SERIES COSTECH FANS

Description: **Axial fan a.c. 80x80x38mm**

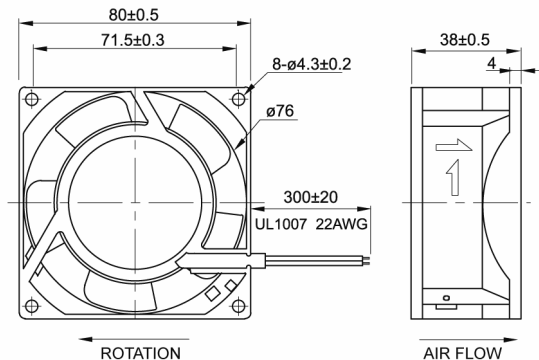

Casing material:	Black varnished aluminum
Impeller material	Black fibreglass reinforced plastic (PBT PC) UL 94V-0
Protection degree:	IP20, according to EN 60529 standard
Fixing system:	by No 4 M4 screws
Motor protection:	Impedance
Storage temperature:	from -40°C to +80°C
Rated temperature range:	from -40°C to +70°C
Lifetime L10 at 40°C:	over 40,000 h
Electrical connection:	2 leads 22AWG UL 1007, 300 mm long.
Approvals:	UL E223195
Weight:	0.28 kg

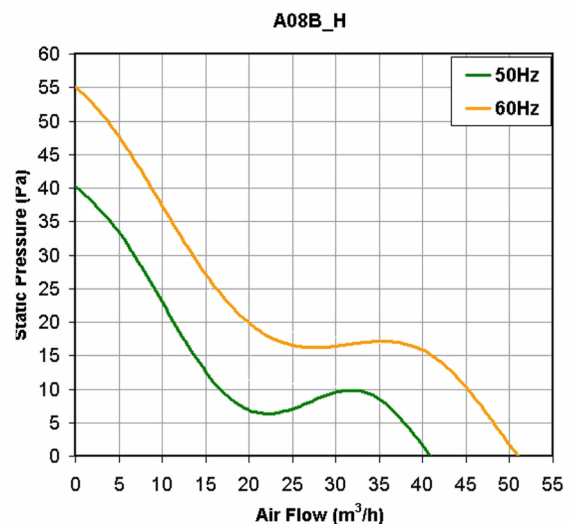
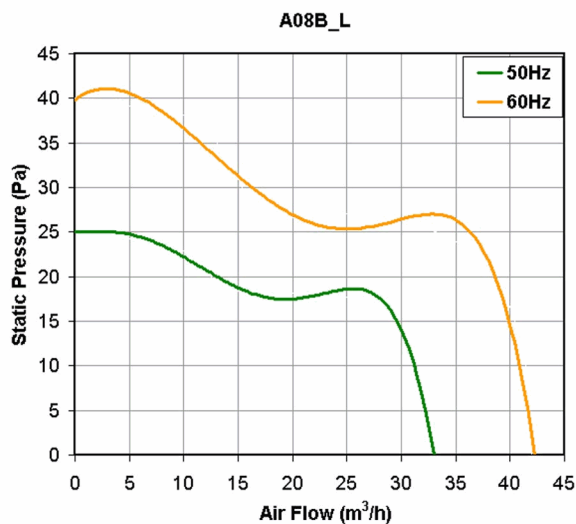

Model	Bearing	Voltage	Frequency	Rated Current	Rated Power	Max Air Flow**	Static Pressure	Noise	RPM	Approvals
		(V)	(Hz)	(A)	(W)	(m³/h)	(Pa)	[db(A)]	(rpm)	
A08B12HWBF00	Ball	115 V a.c.	50/60	0.140/0.120	14/12	41/51	40/55	32.0/36.0	2,500/3,000	CE; cURus
A08B12HWSF00	Sleeve	115 V a.c.	50/60	0.140/0.120	14/12	41/51	40/55	32.0/36.0	2,500/3,000	CE; cURus
A08B12LWBF00	Ball	115 V a.c.	50/60	0.120/0.100	12/9.0	33/42	25/40	28.0/32.0	1,900/2,400	CE; cURus
A08B12LWSF00	Sleeve	115 V a.c.	50/60	0.120/0.100	12/9.0	33/42	25/40	28.0/32.0	1,900/2,400	CE; cURus
A08B23HWBF00	Ball	230 V a.c.	50/60	0.070/0.060	14/12	41/51	40/55	32.0/36.0	2,500/3,000	CE; UR
A08B23HWSF00	Sleeve	230 V a.c.	50/60	0.070/0.060	14/12	41/51	40/55	32.0/36.0	2,500/3,000	CE; UR
A08B23LWBF00	Ball	230 V a.c.	50/60	0.060/0.050	14/12	33/42	25/40	28.0/32.0	1,900/2,400	CE; UR
A08B23LWSF00	Sleeve	230 V a.c.	50/60	0.060/0.050	14/12	33/42	25/40	28.0/32.0	1,900/2,400	CE; UR

"A09AF" SERIES COSTECH FANS

Description: **Axial fan a.c. 92x92x25mm**

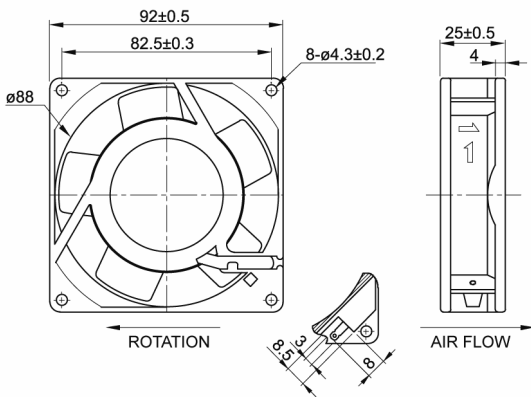

Casing material:

Impeller material

Protection degree:

Fixing system:

Motor protection:

Storage temperature:

Rated temperature range:

Lifetime L10 at 40°C:

Electrical connection:

Approvals:

Weight:

Black varnished aluminum

Black fibreglass reinforced plastic (PBT PC)
UL 94V-0

IP44, according to EN 60529 standard

by No 4 M4 screws

Impedance

from -40°C to +80°C

from -40°C to +70°C (ball bearing)

over 40,000 h (ball bearing);

over 15,000 h (sleeve bearing)

flat terminals 110 series (2.8x0.5 mm)

UL E223195

0.28 kg

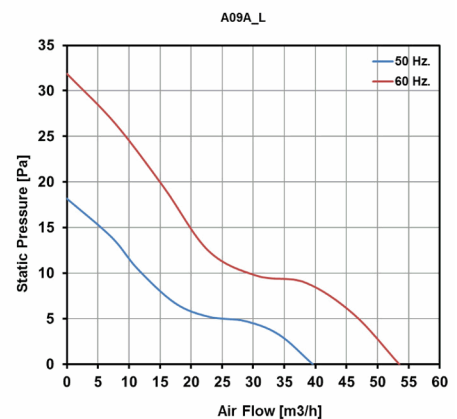
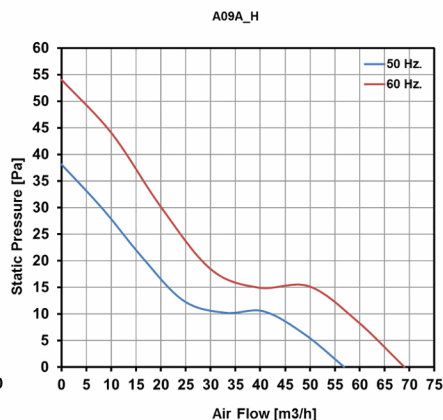
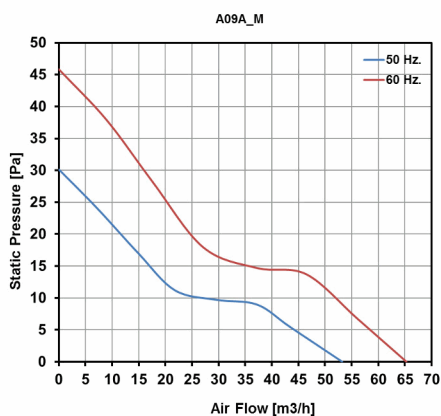

Model	Bearing	Voltage	Frequency	Rated Current	Rated Power	Max Air Flow**	Static Pressure	Noise	RPM	Approvals
		(V)	(Hz)	(A)	(W)	(m3/h)	(Pa)	[db(A)]	(rpm)	
A09A12HTBF00	Ball	115 V a.c.	50/60	0.150/0.120	14/11	56/68	37/54	32.0/36.0	2,500/3,000	CE; cURus
A09A12HTSF00	Sleeve	115 V a.c.	50/60	0.150/0.120	14/11	56/68	37/54	32.0/36.0	2,500/3,000	CE; cURus
A09A23HTBF00	Ball	230 V a.c.	50/60	0.080/0.070	16/14	56/68	37/54	32.0/36.0	2,500/3,000	CE; UR
A09A23HTSF00	Sleeve	230 V a.c.	50/60	0.080/0.070	16/14	56/68	37/54	32.0/36.0	2,500/3,000	CE; UR
A09A23LTBF00	Ball	230 V a.c.	50/60	0.070/0.060	16/14	39/53	17/32	28.0/32.0	1,800/2,300	CE
A09A23LTSF00	Sleeve	230 V a.c.	50/60	0.070/0.060	16/14	39/53	17/32	28.0/32.0	1,800/2,300	CE; cURus
A09A23MTBF00	Ball	230 V a.c.	50/60	0.070/0.060	16/14	51/63	30/45	28.0/32.0	2,200/2,750	CE; UR
A09A23MTSF00	Sleeve	230 V a.c.	50/60	0.070/0.060	16/14	51/63	30/45	28.0/32.0	2,200/2,750	CE; UR

"A12AF" SERIES COSTECH FANS

Description: **Axial fan a.c. 120X120x25mm**

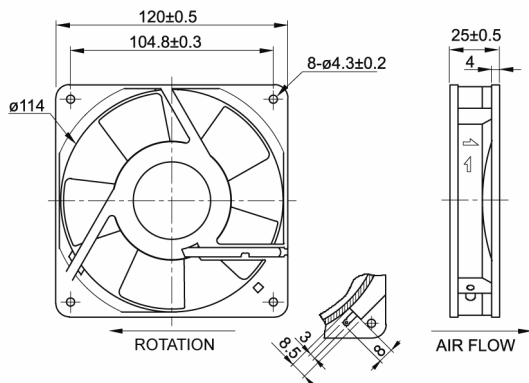

Casing material:	Black varnished aluminum
Impeller material	Black fibreglass reinforced plastic (PBT) UL 94V-0
Protection degree:	IP20 for A12A12MT* and A12A23MT*, IP44 for A12A12HT* and A12A23HT*, according to EN 60529 standard
Fixing system:	by No 4 M4 screws
Motor protection:	Impedance
Storage temperature:	from -40°C to +80°C
Rated temperature range:	from -40°C to +70°C
Lifetime L10 at 40°C:	over 40,000 h (ball bearing); over 15,000 h (sleeve bearing)
Electrical connection:	flat terminals 110 series (2.8x0.5 mm)
Approvals:	UL E223195
Weight:	0.33 kg

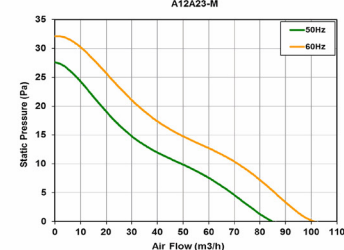
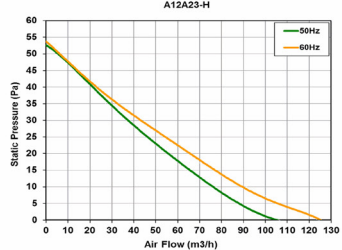
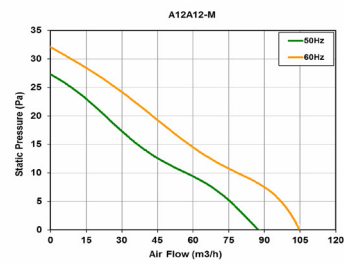
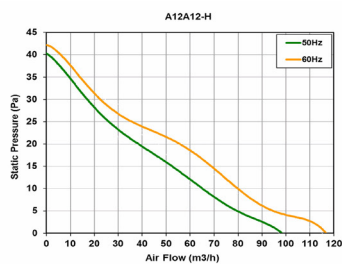

Model	Bearing	Voltage	Frequency	Rated Current	Rated Power	Max Air Flow	Static Pressure	Noise	RPM	Approvals
		(V)	(Hz)	(A)	(W)	(m3/h)	(Pa)	[db(A)]	(rpm)	
A12A12HTBF00	Ball	115 V a.c.	50/60	0.150/0.120	14/11	99/117	42/40	38.0/42.0	2,400/2,900	CE; cURus;
A12A12HTSF00	Sleeve	115 V a.c.	50/60	0.150/0.120	14/11	99/117	42/40	38.0/42.0	2,400/2,900	CE; cURus;
A12A12MTBF00	Ball	115 V a.c.	50/60	0.150/0.120	14/11	87/105	27/32	33.0/35.0	2,050/2,500	CE; cURus;
A12A12MTSF00	Sleeve	115 V a.c.	50/60	0.150/0.120	14/11	87/105	27/32	33.0/35.0	2,050/2,500	CE; cURus;
A12A23HTBF00	Ball	230 V a.c.	50/60	0.080/0.070	16/14	109/127	52/52	38.0/42.0	2,400/2,900	CE; UR;
A12A23HTSF00	Sleeve	230 V a.c.	50/60	0.080/0.070	16/14	109/127	52/52	38.0/42.0	2,400/2,900	CE; UR;
A12A23MTBF00	Ball	230 V a.c.	50/60	0.070/0.060	16/14	87/102	27/32	34.0/36.0	2,000/2,400	CE; UR;
A12A23MTSF00	Sleeve	230 V a.c.	50/60	0.070/0.060	16/14	87/102	27/32	34.0/36.0	2,000/2,400	CE; UR;

"A12BW" SERIES COSTECH FANS

Description: **Axial fan a.c. 120X120x38mm**

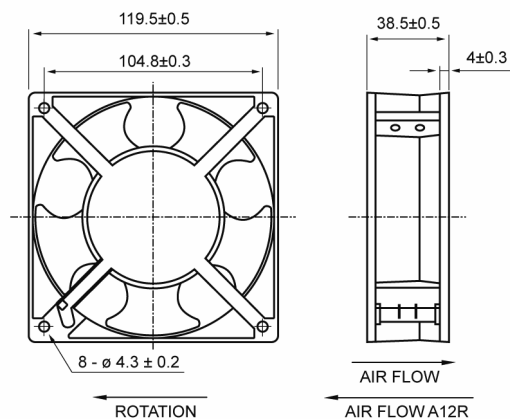

Casing material:

Impeller material

Protection degree:

Insulation class:

Fixing system:

Motor protection:

Storage temperature:

Rated temperature range:

Lifetime L10 at 40°C:

Electrical connection:

Weight:

Approvals:

die-casting aluminium painted black

black thermoplastic UL 94V-0

IP20, according to EN 60529 standard

A

4 holes Ø4.3 mm

impedance

from -40°C to +70°C

from -10°C to +60°C

30.000 h

flat terminals

0.550 kg

UL E223195; VDE 40009963

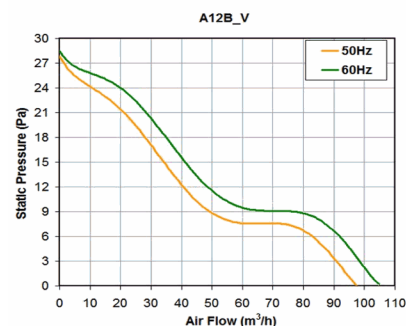
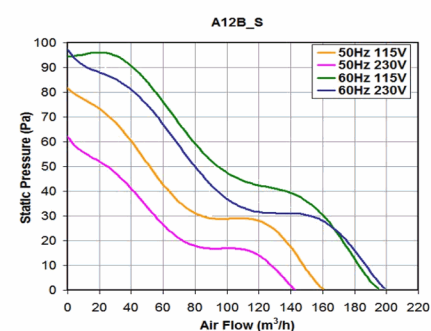
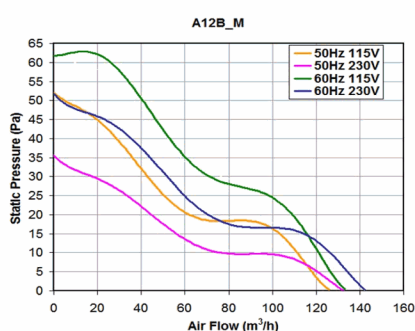
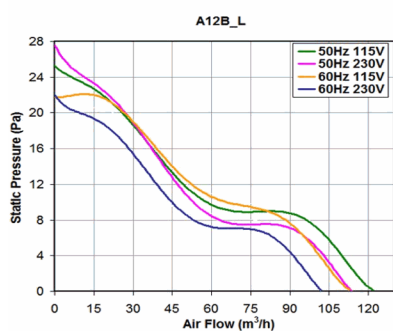
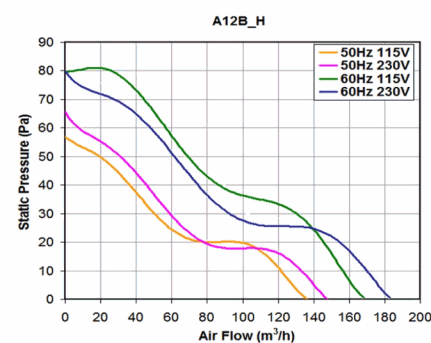
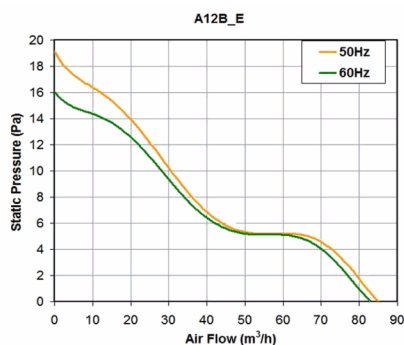
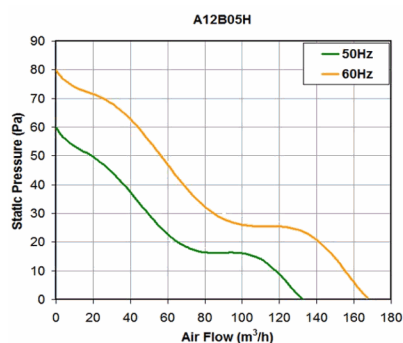

Model	Bearing	Voltage	Frequency	Rated Current	Rated Power	Max Air Flow	Static Pressure	Noise	RPM	Approvals
		(V)	(Hz)	(A)	(W)	(m3/h)	(Pa)	[db(A)]	(rpm)	
A12B12HTBW00	Ball	115 V a.c.	50/60	0.210/0.180	20/18	148/182	65/80	46.0/49.0	2,750/3,050	CE; cURus; VDE;
A12B12HTSW00	Sleeve	115 V a.c.	50/60	0.210/0.180	20/18	138/178	55/75	44.0/48.0	2,750/3,050	CE; cURus; VDE;
A12B12LTBW00	Ball	115 V a.c.	50/60	0.120/0.130	11/11	133/122	35/32	42.0/40.0	2,300/2,100	CE; cURus; VDE;
A12B12LTSW00	Sleeve	115 V a.c.	50/60	0.130/0.110	11/11	115/104	35/20	41.0/37.0	2,200/1,800	CE; cURus; VDE;
A12B12MTBW00	Ball	115 V a.c.	50/60	0.170/0.160	16/15	136/143	52/62	44.0/46.0	2,500/2,700	CE; cURus; VDE;
A12B12MTSW00	Sleeve	115 V a.c.	50/60	0.170/0.160	16/15	129/141	50/52	44.0/46.0	2,400/2,600	CE; cURus; VDE;
A12B12STBW00	Ball	115 V a.c.	50/60	0.260/0.240	22/20	165/182	75/95	48.0/50.0	2,850/3,150	CE; cURus; VDE;
A12B12STSW00	Sleeve	115 V a.c.	50/60	0.260/0.240	22/23.8	165/182	62/95	47.0/50.0	2,700/3,100	CE; cURus; VDE;
A12B12VTBW00	Ball	115 V a.c.	50/60	0.096/0.089	8.1/7.5	98/105	28/28	37.0/38.0	1,850/1,900	CE; VDE
A12B23ETBW00	Ball	230 V a.c.	50/60	0.035/0.035	6.5/6.0	83/82	16/16	29.0/28.0	1,500/1,450	CE; VDE
A12B23ETSW00	Sleeve	230 V a.c.	50/60	0.04/0.04	6.5/6.0	83/82	16/16	29.0/28.0	1,500/1,450	CE; VDE
A12B23HTBW00	Ball	230 V a.c.	50/60	0.130/0.110	20/19	139/182	60/80	46.0/49.0	2,750/3,050	CE; cURus; VDE;
A12B23HTSW00	Sleeve	230 V a.c.	50/60	0.130/0.110	20/19	138/178	55/75	44.0/48.0	2,55/2,900	CE; cURus; VDE;
A12B23LTBW00	Ball	230 V a.c.	50/60	0.050/0.060	11/10	114/102	27/22	44.0/42.0	2,200/1,800	CE; cURus; VDE;
A12B23LTSW00	Sleeve	230 V a.c.	50/60	0.050/0.060	11/10	115/104	35/20	41.0/37.0	2,200/1,800	CE; cURus; VDE;
A12B23MTBW00	Ball	230 V a.c.	50/60	0.090/0.080	16/15	133/143	47/57	43.0/45.0	2,400/2,600	CE; cURus; VDE;
A12B23MTSW00	Sleeve	230 V a.c.	50/60	0.090/0.080	16/15	129/141	50/52	44.0/46.0	2,300/2,500	CE; cURus; VDE;
A12B23STBW00	Ball	230 V a.c.	50/60	0.140/0.120	22/21	143/199	62/97	47.0/50.0	2,700/3,100	CE; cURus; VDE;
A12B23STSW00	Sleeve	230 V a.c.	50/60	0.140/0.120	22/21	141/182	62/95	47.0/50.0	2,600/3,100	CE; cURus; VDE;
A12B23VTBW00	Ball	230 V a.c.	50/60	0.050/0.050	10/10	98/105	27/27	37.0/38.0	1,850/1,900	CE; VDE;
A12B05HTBW00	Ball	24 V a.c.	50/60	0.80/0.77	14/14	129/142	55/40	45.0/48.0	2,550/2,800	CE;
A12B05HTSW00	Sleeve	24 V a.c.	50/60	0.75/0.73	13.2/13.2	147/142	55/50	46.0/45.0	2,530/2,430	CE;
A12B05LTBW00	Ball	24 V a.c.	50/60	0.71/0.65	13/12	105/115	30/30	38.0/40.0	1,920/2,090	CE;

A12B12HWW00

AC axial fans



Axial fans provide forced-air cooling solution to temperature-sensitive applications. Compact fans with AC shaded pole or capacitor and DC brushless motor are designed for ventilation and spot cooling of internal machinery components, especially in areas in confined spaces. Available also versions tested to withstand harsh environmental conditions (IP55, IP68, all metal and HTR fans).

Technical data		
APPROVALS		
Approvals	CE; cURus; VDE	
PERFORMANCE		
Max Airflow	148/182 87/107	m³/h CFM
Max Static Pressure	65/80 0.26/0.32	Pa in H2O
RPM	2750/3050	RPM
ELECTRICAL DATA		
Rated Voltage	115	V a.c.
Rated Current	0.21/0.18	A
Rated Power	20/18	W
Operating Voltage	85-125	V a.c.
Frequency	50/60	Hz
Appliance Class	I	
Insulation Class	A	
Motor Protection	Impedance Protected	
MECHANICAL DATA		
Bearing	Ball Bearing	
GENERIC DATA		
Casing Material	Die-Casting Aluminium	
Airflow Direction	Air exhaust over brackets	

A12B12HWBW00

AC axial fans

Technical data

Electrical Connection	Wires	
Life Expectancy	40000	h at 25 °C
	40000	h at 77 °F
Fan Noise	46/49	dB(A)
Cable Length	310	mm
	12.20	in
Fixing System	Screws	
ENVIRONMENTAL AND THERMAL DATA		
IP Protection Degree	IP20	
Operating Temperature	-10÷60	°C
	14÷140	°F
Storage Temperature	-40÷70	°C
	-40÷158	°F
UL DATA		
UL File Number Recognized Component	E223195	

Technical drawing mm (in)

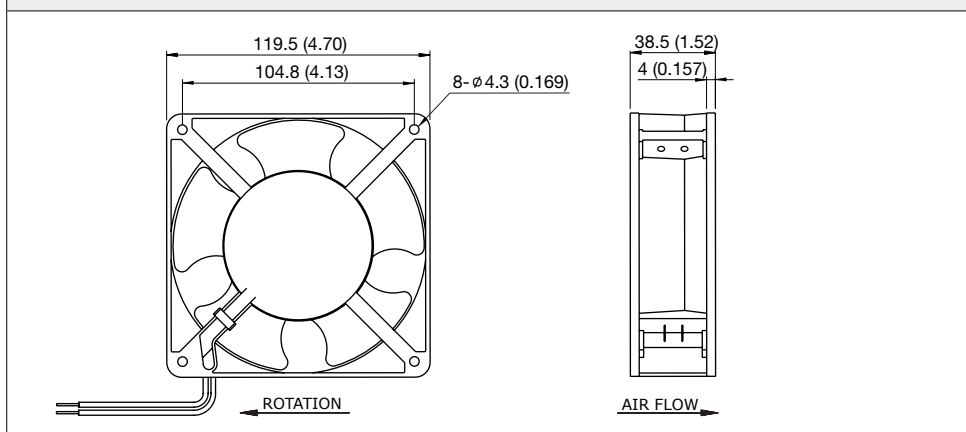

Air Performance

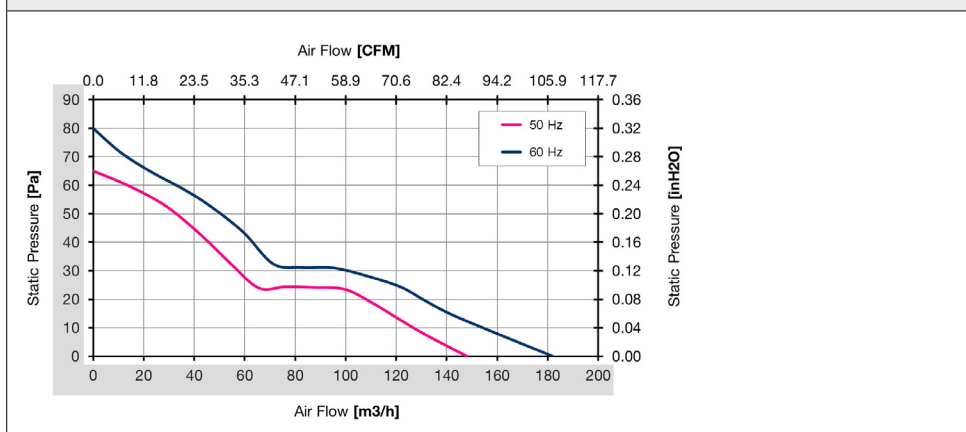

A12BMT SERIES

Description: **Axial fan a.c. 120x120x38mm**

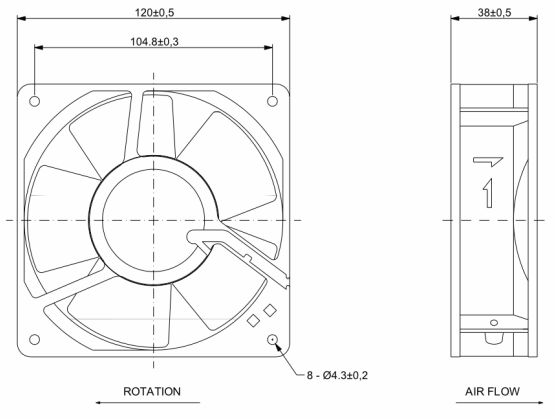

Casing material:	Black varnished aluminum
Impeller material	Metal
Protection degree:	IP20, according to EN 60529 standard
Fixing system:	by No 2 M4 screws
Insulation class:	F
Motor protection:	thermal
Storage temperature:	from -40°C to +90°C
Rated temperature range:	from -40°C to +90°C
Lifetime L10 at 40°C:	40,000 h
Electrical connection:	N°2 male faston 2.8x0.8
Approvals:	UL E223195
Weight:	0.55 kg

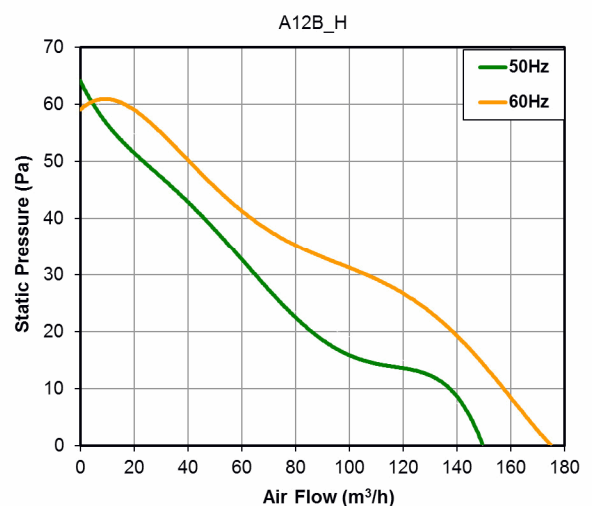
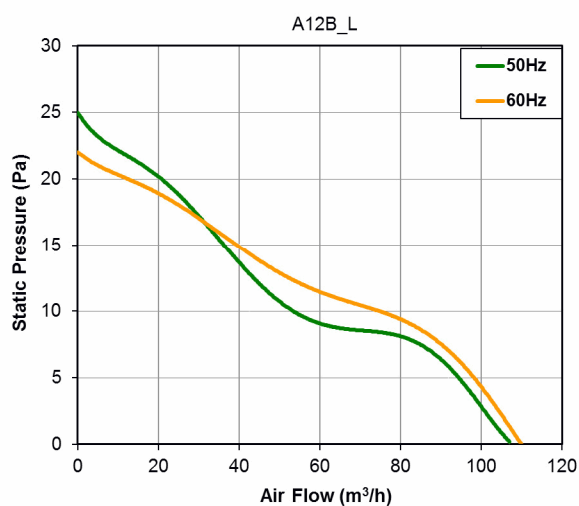

Model	Bearing	Voltage	Frequency	Rated Current	Rated Power	Max Air Flow**	Static Pressure	Noise	RPM	Approvals
		(V)	(Hz)	(A)	(W)	(m³/h)	(Pa)	[db(A)]	(rpm)	
A12B12HTBMT0	Ball	115 V a.c.	50/60	0.100/0.090	17/15	150/175	64/59	42.0/46.0	2,700/3,100	CE
A12B12LTBMT0	Ball	115 V a.c.	50/60	0.060/0.050	17/15	110/115	25/22	33.0/35.0	2,000/2,050	CE
A12B23HTBMT0	Ball	230 V a.c.	50/60	0.100/0.090	17/15	150/175	64/59	42.0/46.0	2,700/3,100	CE; cURus
A12B23LTBMT0	Ball	230 V a.c.	50/60	0.060/0.050	17/15	110/115	25/22	33.0/35.0	2,000/2,050	CE; cURus

A12B23SWBW00

AC axial fans



Axial fans provide forced-air cooling solution to temperature-sensitive applications. Compact fans with AC shaded pole or capacitor and DC brushless motor are designed for ventilation and spot cooling of internal machinery components, especially in areas in confined spaces. Available also versions tested to withstand harsh environmental conditions (IP55, IP68, all metal and HTR fans).

Technical data		
APPROVALS		
Approvals	CE; cURus; VDE	
PERFORMANCE		
Max Airflow	143/199	m³/h
	84/117	CFM
Max Static Pressure	62/97	Pa
	0.25/0.39	in H2O
RPM	2700/3100	RPM
ELECTRICAL DATA		
Rated Voltage	230	V a.c.
Rated Current	0.14/0.12	A
Rated Power	22/21	W
Operating Voltage	216-244	V a.c.
Frequency	50/60	Hz
Appliance Class	I	
Insulation Class	A	
Motor Protection	Impedance Protected	
MECHANICAL DATA		
Bearing	Ball Bearing	
GENERIC DATA		
Casing Material	Die-Casting Aluminium	
Airflow Direction	Air exhaust over brackets	

A12B23SWBW00

AC axial fans

Technical data

Electrical Connection	Wires	
Life Expectancy	40000	h at 25 °C
	40000	h at 77 °F
Fan Noise	47/50	dB(A)
Cable Length	310	mm
	12.20	in
Fixing System	Screws	
ENVIRONMENTAL AND THERMAL DATA		
IP Protection Degree	IP20	
Operating Temperature	-10÷60	°C
	14÷140	°F
Storage Temperature	-40÷70	°C
	-40÷158	°F
UL DATA		
UL File Number Recognized Component	E223195	

Technical drawing mm (in)

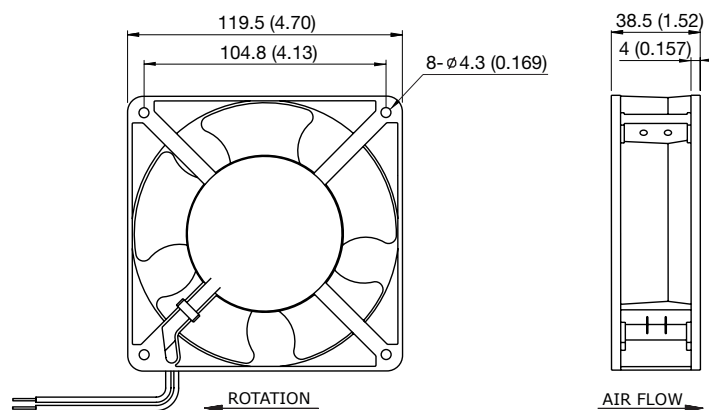

Air Performance

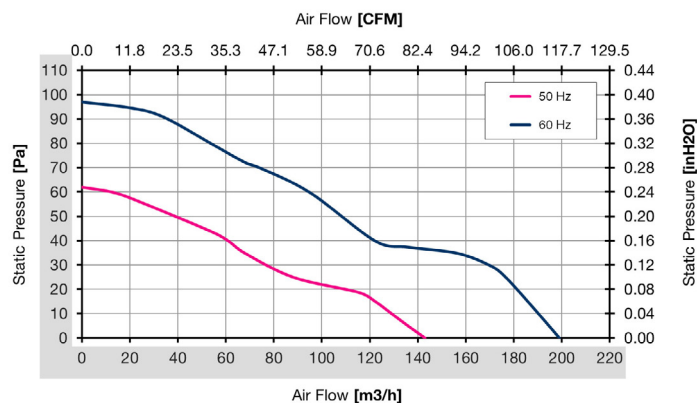

A12BMT SERIES

Description: **Axial fan a.c. 120x120x38mm**

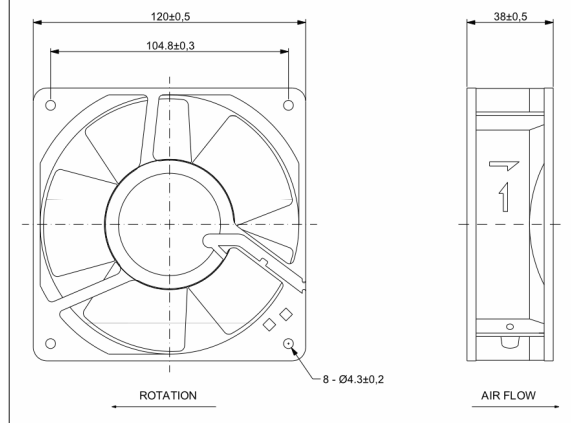

Casing material:	Black varnished aluminum
Impeller material	Metal
Protection degree:	IP20, according to EN 60529 standard
Fixing system:	by No 2 M4 screws
Insulation class:	F
Motor protection:	thermal
Storage temperature:	from -40°C to +90°C
Rated temperature range:	from -40°C to +90°C
Lifetime L10 at 40°C:	40,000 h
Electrical connection:	N°2 male faston 2.8x0.8
Approvals:	UL E223195
Weight:	0.55 kg

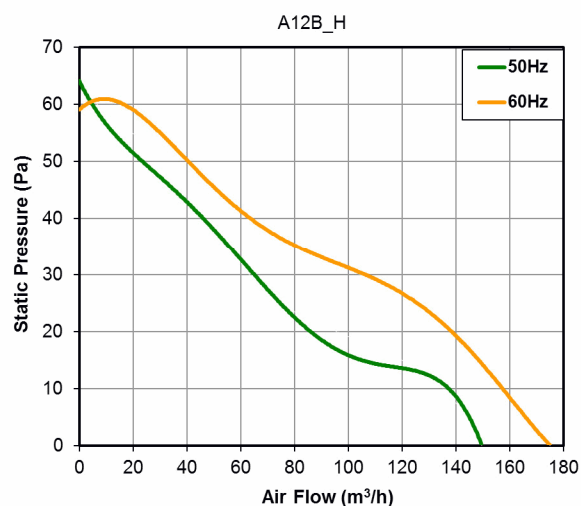
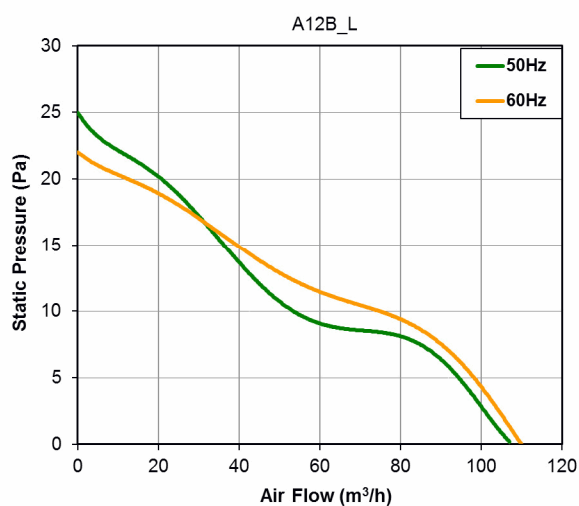

Model	Bearing	Voltage	Frequency	Rated Current	Rated Power	Max Air Flow**	Static Pressure	Noise	RPM	Approvals
		(V)	(Hz)	(A)	(W)	(m³/h)	(Pa)	[db(A)]	(rpm)	
A12B12HTBMT0	Ball	115 V a.c.	50/60	0.100/0.090	17/15	150/175	64/59	42.0/46.0	2,700/3,100	CE
A12B12LTBMT0	Ball	115 V a.c.	50/60	0.060/0.050	17/15	110/115	25/22	33.0/35.0	2,000/2,050	CE
A12B23HTBMT0	Ball	230 V a.c.	50/60	0.100/0.090	17/15	150/175	64/59	42.0/46.0	2,700/3,100	CE; cURus
A12B23LTBMT0	Ball	230 V a.c.	50/60	0.060/0.050	17/15	110/115	25/22	33.0/35.0	2,000/2,050	CE; cURus

"A12B23HWW00" COSTECH FANS

Description: **Axial fan a.c. 120X120x38mm**

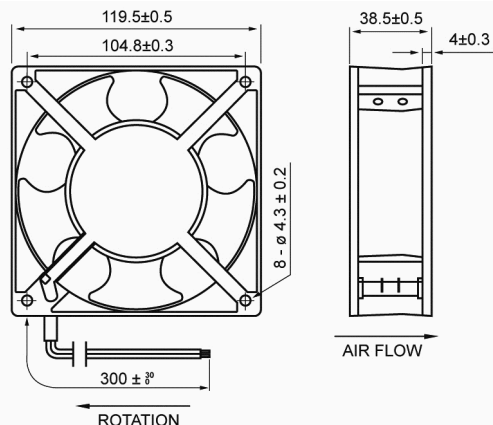

Casing material:	die-casting aluminium painted black
Impeller material	black thermoplastic UL 94V-0
Protection degree:	IP20, according to EN 60529 standard
Fixing system:	by No 2x 4 holes Ø4.3mm
Motor protection:	impedance
Insulation class:	A
Electrical connection:	2 leads 24 AWG UL, 300mm long
Storage temperature range:	from -40°C to +70°C
Rated temperature range:	from -10°C to +60°C
Lifetime L10 at 25°C:	40,000h
Weight:	0.53kg
Approvals:	CE, UL E223195, VDE 40009963

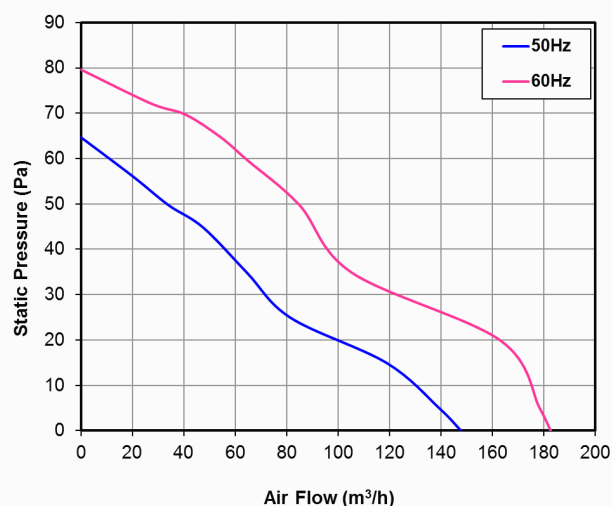

Model	Bearing	Voltage	Frequency	Rated Current	Rated Power	Max Air Flow	Static Pressure	Noise	RPM	Approvals
		(V)	(Hz)	(A)	(W)	(m3/h)	(Pa)	[db(A)]	(rpm)	
A12B23HWW00	Ball	230 V a.c.	50/60	0.130/0.110	20/19	148/182	65/80	46.0/49.0	2,600/3,050	CE; cURus; VDE;

data with uncertainty of 15%

"A12BW" SERIES COSTECH FANS

Description: **Axial fan a.c. 120X120x38mm**

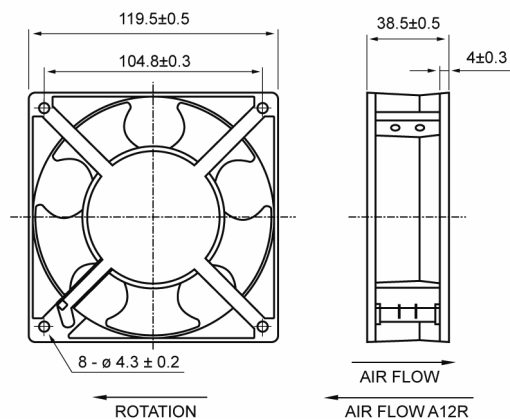

Casing material:

Impeller material

Protection degree:

Insulation class:

Fixing system:

Motor protection:

Storage temperature:

Rated temperature range:

Lifetime L10 at 40°C:

Electrical connection:

Weight:

Approvals:

die-casting aluminium painted black

black thermoplastic UL 94V-0

IP20, according to EN 60529 standard

A

4 holes Ø4.3 mm

impedance

from -40°C to +70°C

from -10°C to +60°C

30.000 h

flat terminals

0.550 kg

UL E223195; VDE 40009963

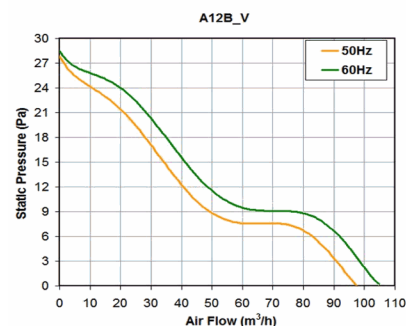
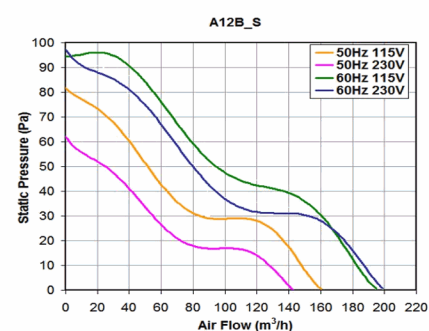
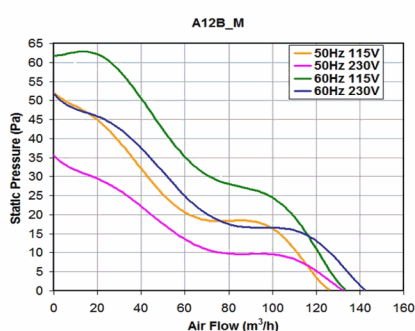
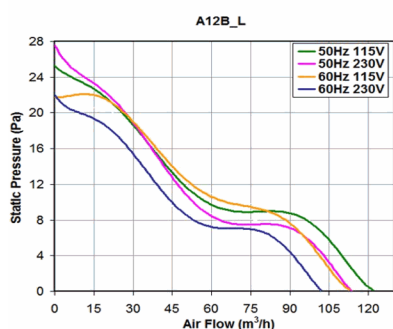
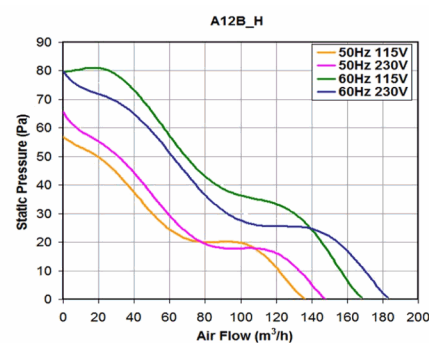
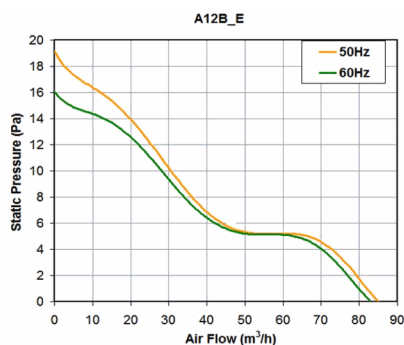
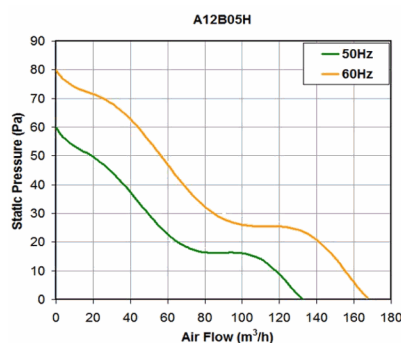

Model	Bearing	Voltage	Frequency	Rated Current	Rated Power	Max Air Flow	Static Pressure	Noise	RPM	Approvals
		(V)	(Hz)	(A)	(W)	(m ³ /h)	(Pa)	[db(A)]	(rpm)	
A12B12HTBW00	Ball	115 V a.c.	50/60	0.210/0.180	20/18	148/182	65/80	46.0/49.0	2,750/3,050	CE; cURus; VDE;
A12B12HTSW00	Sleeve	115 V a.c.	50/60	0.210/0.180	20/18	138/178	55/75	44.0/48.0	2,750/3,050	CE; cURus; VDE;
A12B12LTBW00	Ball	115 V a.c.	50/60	0.120/0.130	11/11	133/122	35/32	42.0/40.0	2,300/2,100	CE; cURus; VDE;
A12B12LTSW00	Sleeve	115 V a.c.	50/60	0.130/0.110	11/11	115/104	35/20	41.0/37.0	2,200/1,800	CE; cURus; VDE;
A12B12MTBW00	Ball	115 V a.c.	50/60	0.170/0.160	16/15	136/143	52/62	44.0/46.0	2,500/2,700	CE; cURus; VDE;
A12B12MTSW00	Sleeve	115 V a.c.	50/60	0.170/0.160	16/15	129/141	50/52	44.0/46.0	2,400/2,600	CE; cURus; VDE;
A12B12STBW00	Ball	115 V a.c.	50/60	0.260/0.240	22/20	165/182	75/95	48.0/50.0	2,850/3,150	CE; cURus; VDE;
A12B12STSW00	Sleeve	115 V a.c.	50/60	0.260/0.240	22/23.8	165/182	62/95	47.0/50.0	2,700/3,100	CE; cURus; VDE;
A12B12VTBW00	Ball	115 V a.c.	50/60	0.096/0.089	8.1/7.5	98/105	28/28	37.0/38.0	1,850/1,900	CE; VDE
A12B23ETBW00	Ball	230 V a.c.	50/60	0.035/0.035	6.5/6.0	83/82	16/16	29.0/28.0	1,500/1,450	CE; VDE
A12B23ETSW00	Sleeve	230 V a.c.	50/60	0.04/0.04	6.5/6.0	83/82	16/16	29.0/28.0	1,500/1,450	CE; VDE
A12B23HTBW00	Ball	230 V a.c.	50/60	0.130/0.110	20/19	139/182	60/80	46.0/49.0	2,750/3,050	CE; cURus; VDE;
A12B23HTSW00	Sleeve	230 V a.c.	50/60	0.130/0.110	20/19	138/178	55/75	44.0/48.0	2,55/2,900	CE; cURus; VDE;
A12B23LTBW00	Ball	230 V a.c.	50/60	0.050/0.060	11/10	114/102	27/22	44.0/42.0	2,200/1,800	CE; cURus; VDE;
A12B23LTSW00	Sleeve	230 V a.c.	50/60	0.050/0.060	11/10	115/104	35/20	41.0/37.0	2,200/1,800	CE; cURus; VDE;
A12B23MTBW00	Ball	230 V a.c.	50/60	0.090/0.080	16/15	133/143	47/57	43.0/45.0	2,400/2,600	CE; cURus; VDE;
A12B23MTSW00	Sleeve	230 V a.c.	50/60	0.090/0.080	16/15	129/141	50/52	44.0/46.0	2,300/2,500	CE; cURus; VDE;
A12B23STBW00	Ball	230 V a.c.	50/60	0.140/0.120	22/21	143/199	62/97	47.0/50.0	2,700/3,100	CE; cURus; VDE;
A12B23STSW00	Sleeve	230 V a.c.	50/60	0.140/0.120	22/21	141/182	62/95	47.0/50.0	2,600/3,100	CE; cURus; VDE;
A12B23VTBW00	Ball	230 V a.c.	50/60	0.050/0.050	10/10	98/105	27/27	37.0/38.0	1,850/1,900	CE; VDE;
A12B05HTBW00	Ball	24 V a.c.	50/60	0.80/0.77	14/14	129/142	55/40	45.0/48.0	2,550/2,800	CE;
A12B05HTSW00	Sleeve	24 V a.c.	50/60	0.75/0.73	13.2/13.2	147/142	55/50	46.0/45.0	2,530/2,430	CE;
A12B05LTBW00	Ball	24 V a.c.	50/60	0.71/0.65	13/12	105/115	30/30	38.0/40.0	1,920/2,090	CE;

A12W23HWBW00

AC axial fans



Axial fans provide forced-air cooling solution to temperature-sensitive applications. Compact fans with AC shaded pole or capacitor and DC brushless motor are designed for ventilation and spot cooling of internal machinery components, especially in areas in confined spaces. Available also versions tested to withstand harsh environmental conditions (IP55, IP68, all metal and HTR fans).

Technical data		
APPROVALS		
Approvals	CE; cURus	
PERFORMANCE		
Max Airflow	151/182	m³/h
	89/107	CFM
Max Static Pressure	65/80	Pa
	0.26/0.32	in H2O
RPM	2550/2900	RPM
ELECTRICAL DATA		
Rated Voltage	230	V a.c.
Rated Current	0.125/0.11	A
Rated Power	20/19	W
Operating Voltage	216-244	V a.c.
Frequency	50/60	Hz
Appliance Class	I	
Insulation Class	A	
Motor Protection	Impedance Protected	
MECHANICAL DATA		
Bearing	Ball Bearing	
GENERIC DATA		
Casing Material	Die-Casting Aluminium	
Airflow Direction	Air exhaust over brackets	

A12W23HWW00

AC axial fans

Technical data		
Electrical Connection	Wires	
Life Expectancy	30000	h at 40 °C
	30000	h at 104 °F
Fan Noise	46/49	dB(A)
Cable Length	300	mm
	11.81	in
Fixing System	Screws	
ENVIRONMENTAL AND THERMAL DATA		
IP Protection Degree	IP20	
Operating Temperature	-10÷70	°C
	14÷158	°F
Storage Temperature	-40÷70	°C
	-40÷158	°F
UL DATA		
UL File Number Recognized Component	E223195	

Technical drawing mm (in)
<p>The technical drawing shows two views of the fan. The front view on the left indicates a total diameter of 113.5 mm (4.47 in) and a mounting hole diameter of 45.5 mm (1.79 in). It shows two M4 mounting holes and a cable exit with a diameter of 5 mm (0.197 in). An arrow indicates the direction of rotation. The side view on the right shows a total thickness of 38 mm (1.50 in) and a mounting flange thickness of 3 mm (0.118 in). The central shaft diameter is 6.7 mm (0.264 in). An arrow indicates the direction of air flow.</p>

Air Performance

Air Flow [m3/h]	Static Pressure [Pa] (50 Hz)	Static Pressure [Pa] (60 Hz)
0	65	80
40	55	70
80	30	50
120	20	35
160	0	20
180	0	0

"A17CF" SERIES COSTECH FANS

Description: **Axial fan a.c. 172X150x51mm**

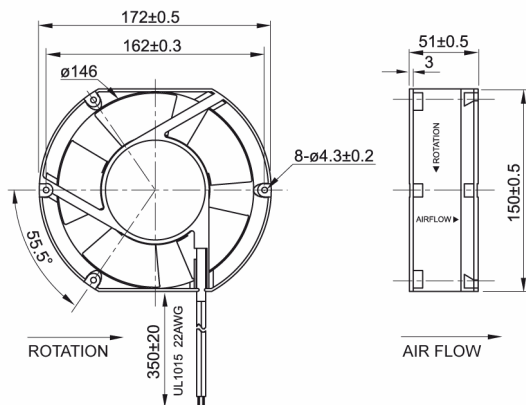

Casing material:	Black varnished aluminum UL 94V-0
Impeller material	Black fibreglass reinforced plastic (PBT PC) UL 94V-0
Protection degree:	IP20, according to EN 60529 standard
Fixing system:	by No 4 M4 screws
Motor protection:	Impedance Protected
Storage temperature:	from -40°C to +80°C
Rated temperature range:	from -40°C to +60°C
Lifetime L10 at 40°C:	40,000 h
Electrical connection:	2 leads 22AWG UL 1015, 350 mm long
Approvals:	UL E223195
Weight:	0,9 kg

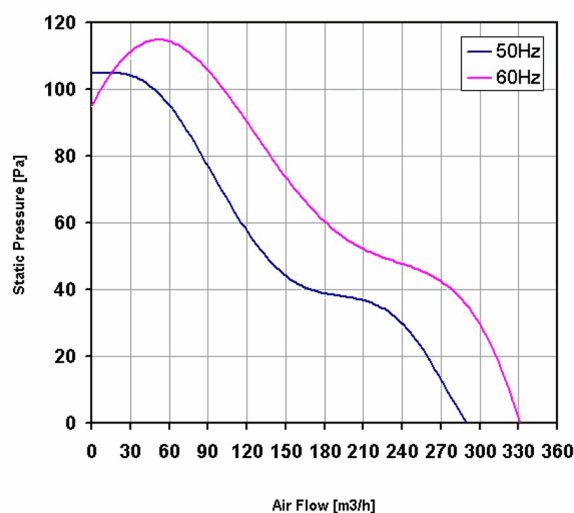

Model	Bearing	Voltage	Frequency	Rated Current	Rated Power	Max Air Flow	Static Pressure	Noise	RPM	Approvals
		(V)	(Hz)	(A)	(W)	(m3/h)	(Pa)	[db(A)]	(rpm)	
A17C12HWBF00	Ball	115 V a.c.	50/60	0.430/0.360	32/28	290/331	105/95	50.0/55.0	2,750/3,100	CE; cURus;
A17C23HWBF00	Ball	230 V a.c.	50/60	0.230/0.180	35/30	290/331	105/95	50.0/55.0	2,750/3,100	CE; cURus;

"A17MM" SERIES COSTECH FANS

Description: **Axial fan a.c. 172X150x55mm**

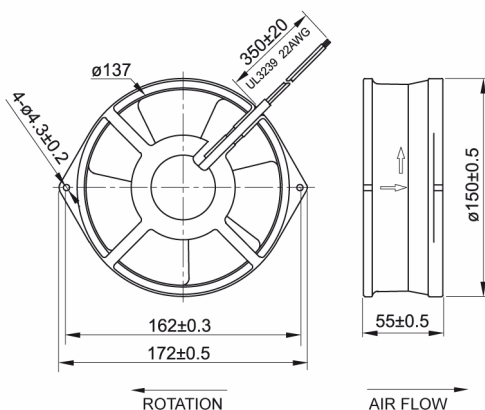

Casing material:	Black varnished aluminum
Impeller material	Metal
Protection degree:	IP44, according to EN 60529 standard
Fixing system:	by No 2 M4 screws
Motor protection:	thermal
Storage temperature:	from -40°C to +80°C
Rated temperature range:	from -40°C to +70°C
Lifetime L10 at 40°C:	40,000 h
Electrical connection:	2 leads 22AWG UL 3239, 350 mm long
Weight:	1.1 kg
Approvals:	UL E223195

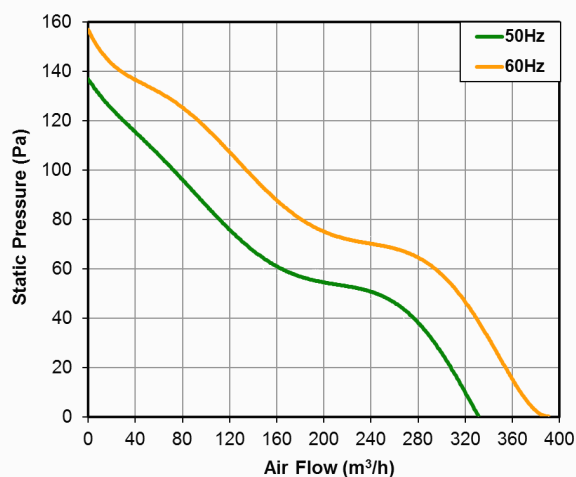

Model	Bearing	Voltage	Frequency	Rated Current	Rated Power	Max Air Flow**	Static Pressure	Noise	RPM	Approvals
		(V)	(Hz)	(A)	(W)	(m3/h)	(Pa)	[db(A)]	(rpm)	
A17M12SWBM00	Ball	115 V a.c.	50/60	0.52/0.470	42/42	332/391	137/157	49.0/53.0	2,800/3,250	CE; cURus
A17M23SWBM00	Ball	230 V a.c.	50/60	0.250/0.230	42/42	332/391	137/157	49.0/53.0	2,800/3,250	CE; cURus

"A17MMT" SERIES COSTECH FANS

Description: **Axial fan a.c. 172X150x55mm**

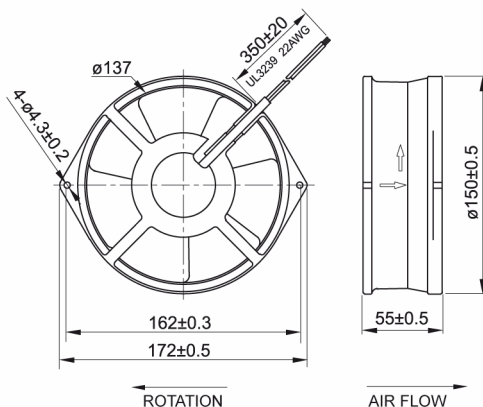

Casing material:	Black varnished aluminum
Impeller material	Metal
Protection degree:	IP44, according to EN 60529 standard
Fixing system:	by No 2 M4 screws
Insulation class:	F
Motor protection:	thermal
Storage temperature:	from -40°C to +90°C
Rated temperature range:	from -40°C to +90°C
Lifetime L10 at 40°C:	40,000 h
Electrical connection:	2 leads 22AWG UL 3239, 350 mm long
Approvals:	UL E223195
Weight:	1.1 kg

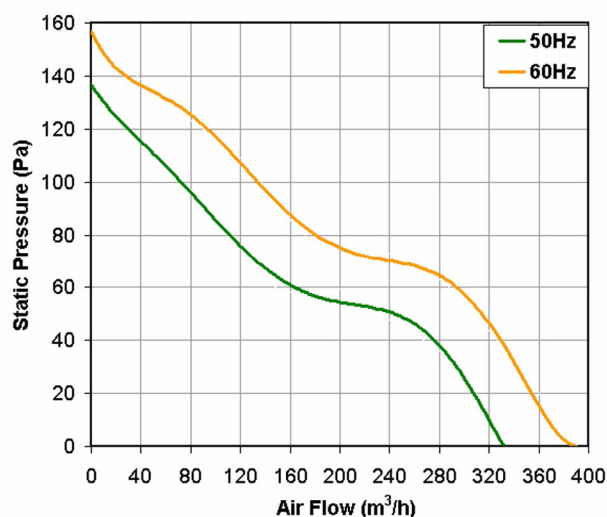

Model	Bearing	Voltage	Frequency	Rated Current	Rated Power	Max Air Flow**	Static Pressure	Noise	RPM	Approvals
		(V)	(Hz)	(A)	(W)	(m3/h)	(Pa)	[db(A)]	(rpm)	
A17M12SWBMT0	Ball	115 V a.c.	50/60	0.52/0.470	42/42	332/391	137/157	49.0/53.0	2,800/3,250	CE; cURus
A17M23SWBMT0	Ball	230 V a.c.	50/60	0.250/0.230	42/42	332/391	137/157	49.0/53.0	2,800/3,250	CE; cURus

"A17TM" SERIES COSTECH FANS

Description: **Axial fan a.c. 172X150x55mm**

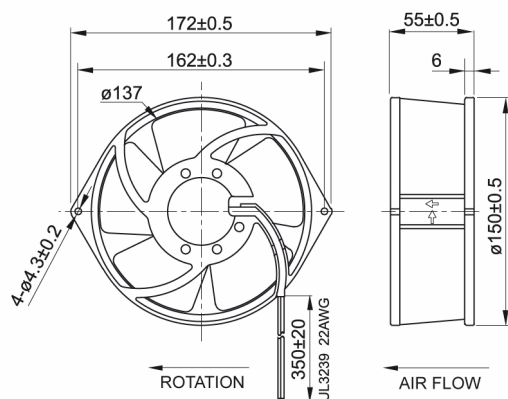

Casing material:	Black varnished aluminum
Impeller material	Metal
Protection degree:	IP20, according to EN 60529 standard
Fixing system:	by No 2 M4 screws
Motor protection:	thermal
Storage temperature:	from -40°C to +90°C
Rated temperature range:	from -40°C to +70°C
Lifetime L10 at 40°C:	40,000 h
Electrical connection:	2 leads 22AWG UL 3239, 350 mm long
Approvals:	UL E223195
Weight:	1.1 kg

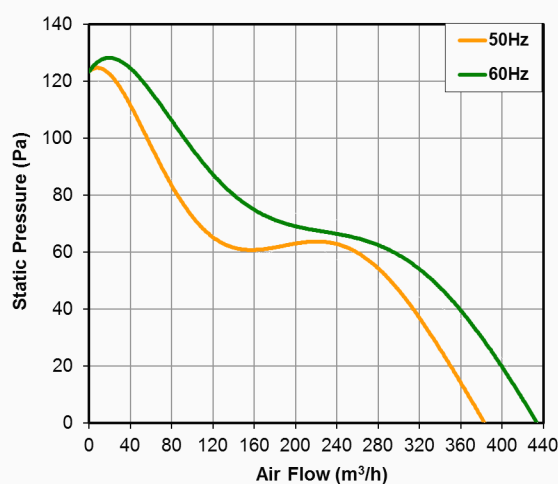

Model	Bearing	Voltage	Frequency	Rated Current	Rated Power	Max Air Flow**	Static Pressure	Noise	RPM	Approvals
		(V)	(Hz)	(A)	(W)	(m3/h)	(Pa)	[db(A)]	(rpm)	
A17T12SWBM00	Ball	115 V a.c.	50/60	0.54/0.51	45/45	383/434	123/126	58.0/61.0	2,750/3,150	CE; cURus
A17T23SWBM00	Ball	230 V a.c.	50/60	0.270/0.250	45/45	383/434	123/126	58.0/61.0	2,750/3,150	CE; cURus

"A17TMT" SERIES COSTECH FANS

Description: **Axial fan a.c. 172X150x55mm**

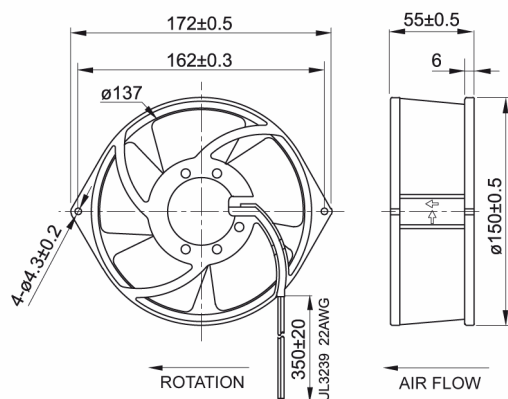

Casing material:	Black varnished aluminum
Impeller material	Metal
Protection degree:	IP44, according to EN 60529 standard
Fixing system:	by 2x No. 4 Ø4.3mm holes
Insulation class:	F
Motor protection:	thermal
Storage temperature:	from -40°C to +90°C
Rated temperature range:	from -40°C to +90°C
Lifetime L10 at 40°C:	40,000 h
Electrical connection:	2 leads 22AWG UL 3239, 350 mm long
Approvals:	UL E223195
Weight:	1.1 kg

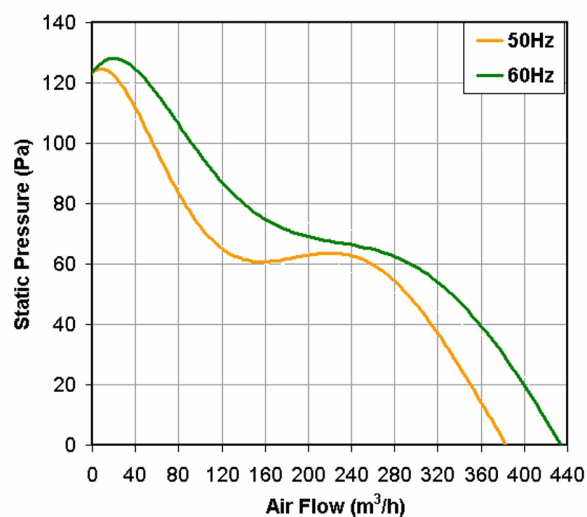

Model	Bearing	Voltage	Frequency	Rated Current	Rated Power	Max Air Flow**	Static Pressure	Noise	RPM	Approvals
		(V)	(Hz)	(A)	(W)	(m3/h)	(Pa)	[db(A)]	(rpm)	
A17T12SWBMT0	Ball	115 V a.c.	50/60	0.54/0.51	45/45	383/434	124/124	58.0/61.0	2,750/3,150	CE; cURus
A17T23SWBMT0	Ball	230 V a.c.	50/60	0.270/0.250	45/45	383/434	124/124	58.0/61.0	2,750/3,150	CE; cURus

A12B23HWBWF0

IP55 AC fans



Axial fans provide forced-air cooling solution to temperature-sensitive applications. Compact fans with AC shaded pole or capacitor and DC brushless motor are designed for ventilation and spot cooling of internal machinery components, especially in areas in confined spaces. Available also versions tested to withstand harsh environmental conditions (IP55, IP68, all metal and HTR fans).

Technical data		
APPROVALS		
Approvals	CE	
PERFORMANCE		
Max Airflow	139/182 82/107	m³/h CFM
Max Static Pressure	60/80 0.24/0.32	Pa in H2O
RPM	2750/3050	RPM
ELECTRICAL DATA		
Rated Voltage	230	V a.c.
Rated Current	0.13/0.11	A
Rated Power	20/19	W
Operating Voltage	207-253	V a.c.
Frequency	50/60	Hz
Appliance Class	I	
Insulation Class	A	
Motor Protection	Impedance Protected	
MECHANICAL DATA		
Bearing	Ball Bearing	
GENERIC DATA		
Casing Material	Die-Casting Aluminium	
Airflow Direction	Air exhaust over brackets	

A12B23HWBWF0

IP55 AC fans

Technical data		
Electrical Connection	Wires	
Life Expectancy	30000	h at 40 °C
	30000	h at 104 °F
Fan Noise	46/49	dB(A)
Cable Length	310	mm
	12.20	in
Fixing System	Screws	
ENVIRONMENTAL AND THERMAL DATA		
IP Protection Degree	IP55	
Operating Temperature	-30÷60	°C
	-22÷140	°F
Storage Temperature	-40÷70	°C
	-40÷158	°F

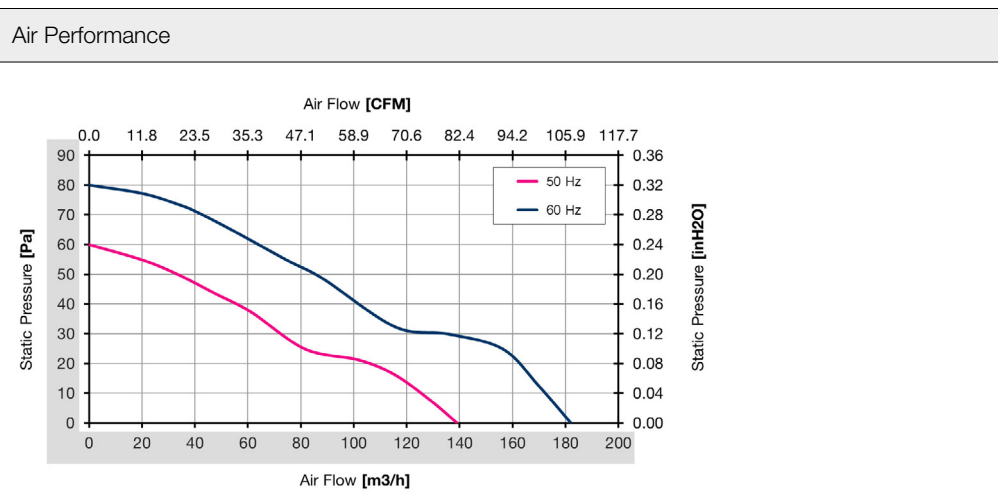
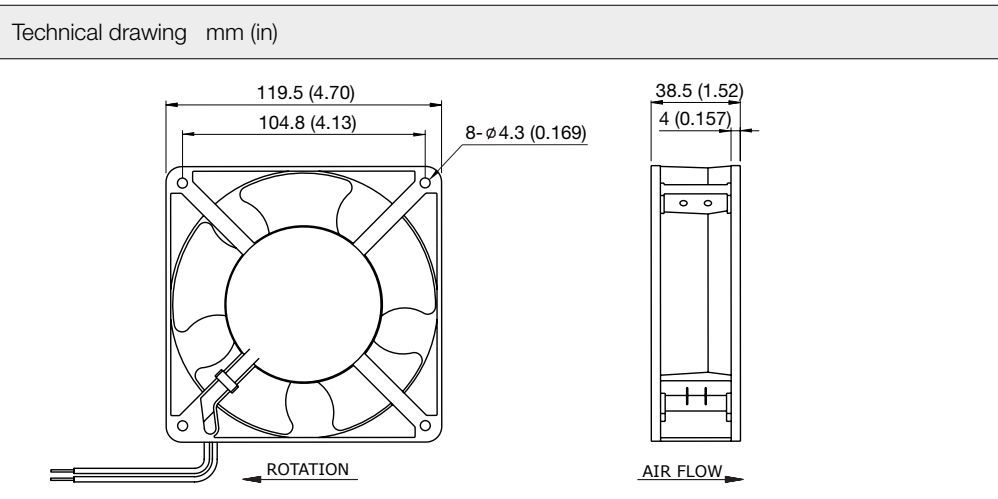

C17BF SERIES

Description: **Axial fan a.c. 172X150x38mm**

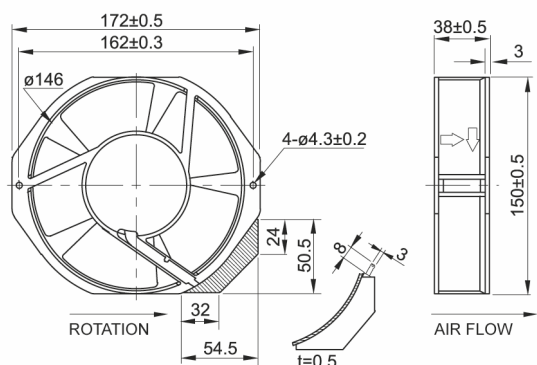

Casing material:

Impeller material

Protection degree:

Fixing system:

Motor protection:

Storage temperature:

Rated temperature range:

Lifetime L10 at 40°C:

Electrical connection:

Approvals:

Weight:

Black varnished aluminum

Black fibreglass reinforced plastic (PBT PC)
UL 94V-0

IP20, according to EN 60529 standard

by No 4 M4 screws

thermal

from -40°C to +80°C

from -40°C to +70°C

40,000 h

flat terminals 110 series (2.8x0.5 mm)

UL E223195

0,72 kg

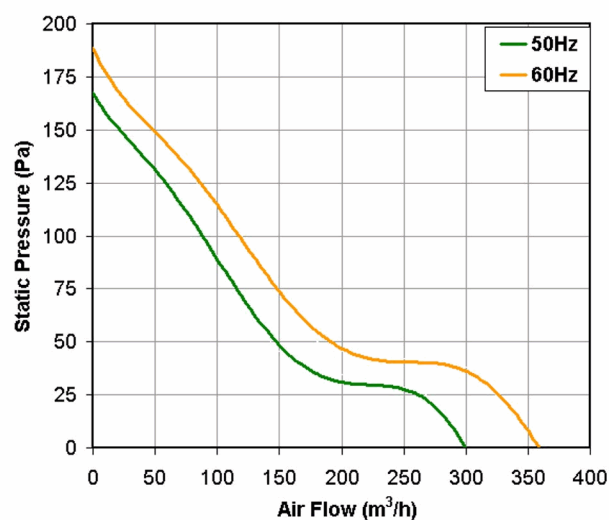

Model	Bearing	Voltage	Frequency	Rated Current	Rated Power	Max Air Flow**	Static Pressure	Noise	RPM	Approvals
		(V)	(Hz)	(A)	(W)	(m3/h)	(Pa)	[db(A)]	(rpm)	
C17B12HTBF00	Ball	115 V a.c.	50/60	0.250/0.230	29/28	300/360	167/187	54.0/58.0	2,850/3,400	CE; cURus
C17B23HTBF00	Ball	230 V a.c.	50/60	0.110/0.110	27/26	300/360	167/187	54.0/58.0	2,850/3,400	CE; cURus

C17CF SERIES

Description: **Axial fan a.c. 172X150x51mm**

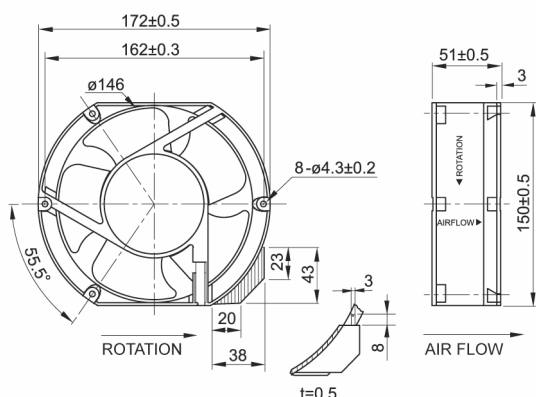

Casing material:	Black varnished aluminum
Impeller material	Black fibreglass reinforced plastic (PBT PC) UL 94V-0
Protection degree:	IP20, according to EN 60529 standard
Fixing system:	by No 4 M4 screws
Motor protection:	thermal
Storage temperature:	from -40°C to +80°C
Rated temperature range:	from -40°C to +70°C
Lifetime L10 at 40°C:	40,000 h
Electrical connection:	flat terminals 110 series (2.8x0.5 mm)
Approvals:	UL E223195
Weight:	0.8 kg

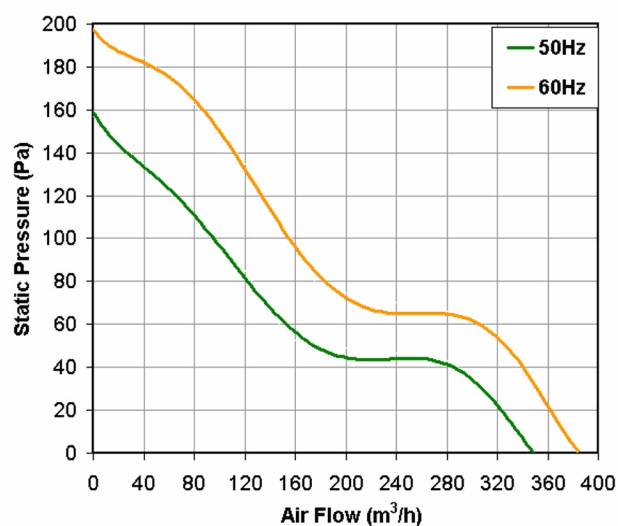

Model	Bearing	Voltage	Frequency	Rated Current	Rated Power	Max Air Flow**	Static Pressure	Noise	RPM	Approvals
		(V)	(Hz)	(A)	(W)	(m³/h)	(Pa)	[db(A)]	(rpm)	
C17C12HTBF00	Ball	115 V a.c.	50/60	0.260/0.250	31/31	348/384	157/197	53.0/58.0	2,850/3,400	CE; cURus
C17C23HTBF00	Ball	230 V a.c.	50/60	0.120/0.120	29/29	348/384	157/197	53.0/58.0	2,850/3,400	CE; cURus

C18CF SERIES

Description: **Axial fan a.c. 172X172x51mm**

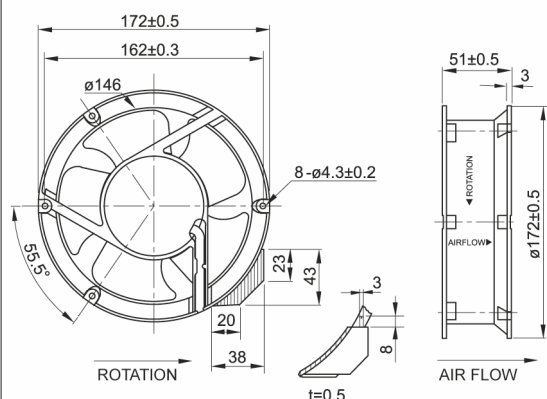

Casing material:

Black varnished aluminum

Impeller material

Black fibreglass reinforced plastic (PBT PC)
UL 94V-0

Protection degree:

IP20, according to EN 60529 standard

Fixing system:

by No 4 M4 screws

Motor protection:

thermal

Storage temperature:

from -40°C to +80°C

Rated temperature range:

from -40°C to +70°C

Lifetime L10 at 40°C:

40,000 h

Electrical connection:

flat terminals 110 series (2.8x0.5 mm)

Approvals:

UL E223195

Weight:

0.82 kg

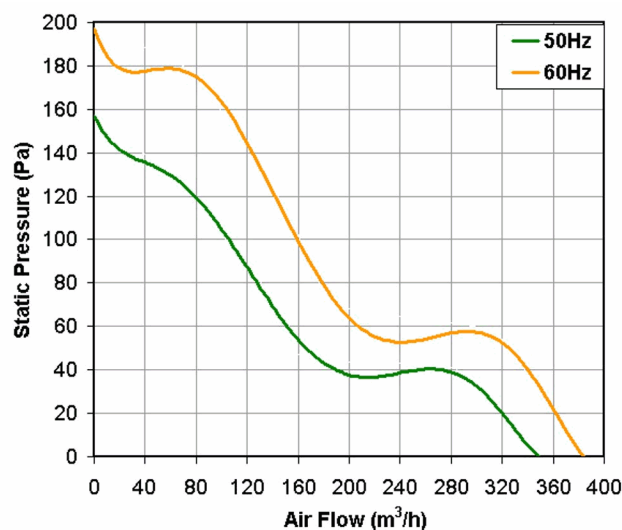

Model	Bearing	Voltage	Frequency	Rated Current	Rated Power	Max Air Flow**	Static Pressure	Noise	RPM	Approvals
		(V)	(Hz)	(A)	(W)	(m³/h)	(Pa)	[db(A)]	(rpm)	
C18C12HTBF00	Ball	115 V a.c.	50/60	0.260/0.250	30/30	348/384	157/197	50.0/55.0	2,850/3,400	CE; cURus
C18C23HTBF00	Ball	230 V a.c.	50/60	0.120/0.120	29/29	348/384	157/197	50.0/55.0	2,850/3,400	CE; cURus

C22SD SERIES

Description: **Axial fan a.c. 218X218X83mm**

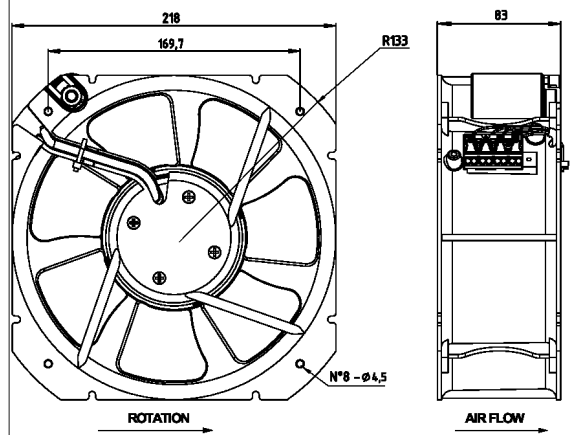

Impeller material:

fibre reinforced plastic (PA66) blades

Casing material:

aluminium alloy die casting UNI5076

Fixing system:

No 4 holes Ø4.5

Motor protection:

thermal

Rated temperature range:

from -20°C to +70°C

Motor Lifetime L10 at 25°C (approx.):

63,000 h

Insulation class:

F

Working class of capacitor:

class B for 115V model

class A for 230V model

Electrical connection:

by screwless terminal block 2.5 mm² (20 - 14 AWG): 3 poles L-N-PE for 115/230Va.c. models; 4 poles L1-L2-L3-PE for 400Va.c. models

Weight:

1,9 kg

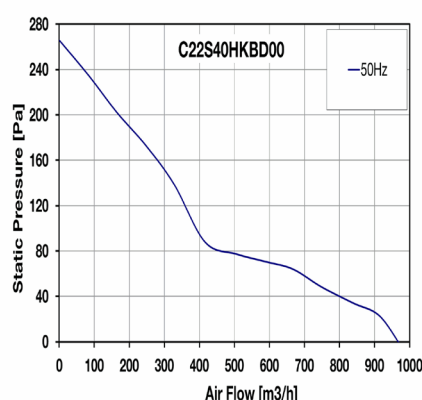
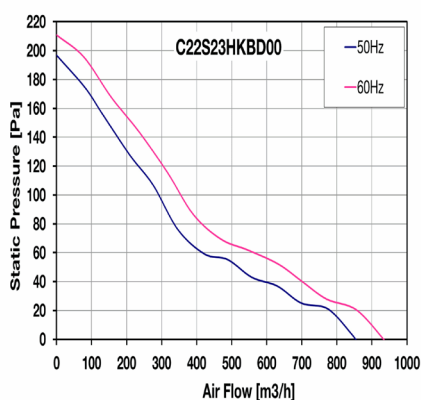
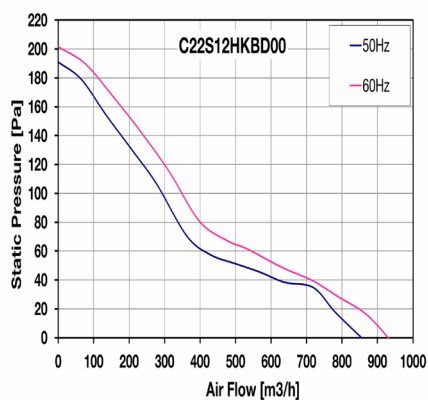

Model	Bearing	Voltage	Frequency	Rated Current	Rated Power	Max Air Flow**	Static Pressure	Noise	RPM	Approvals
		(V)	(Hz)	(A)	(W)	(m3/h)	(Pa)	[db(A)]	(rpm)	
C22S12HKBD00	Ball	115 V a.c.	50/60	0.79/0.83	79/96	855/930	190/201	64.6/67.4	2,490/2,760	CE
C22S23HKBD00	Ball	230 V a.c.	50/60	0.343/0.411	78/94	855/930	197/211	65.0/68.0	2,490/2,750	CE
C22S40HKBD00	Ball	400 V 3 ~	50	0.280	174	970	265	61.0	2,770	CE

C25SE SERIES

Description: **Axial fan a.c. 280X280X80mm**

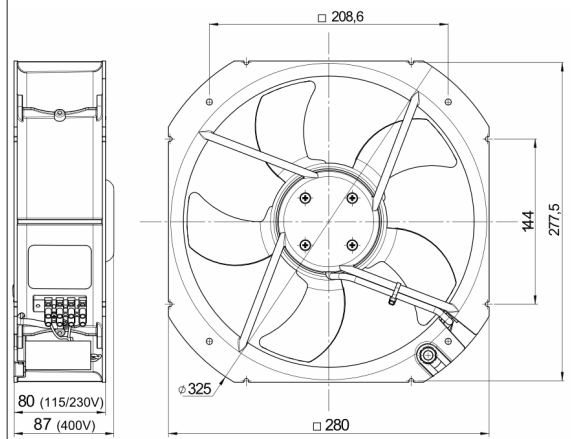

Fan material:

casing of aluminium alloy die casting and black painted steel

Casing material:

aluminium UNI5076

Fixing system:

No 4 holes Ø5.4

Motor protection:

thermally

Rated temperature range:

from -20°C to +70°C

Motor Lifetime L10 at 25°C

da 53,000 a 80,000 h

(approx.):

Electrical connection:

by terminal block 3 pins (L-N-PE)

Weight:

2,800 kg

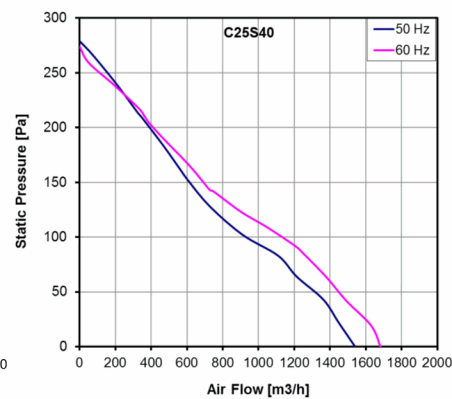
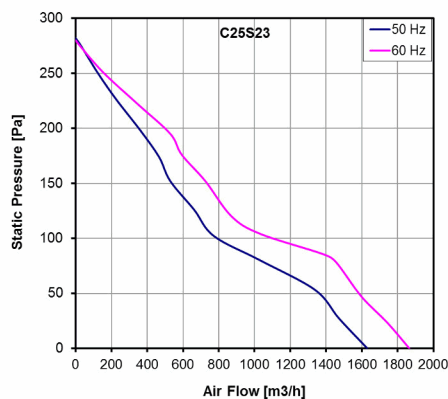
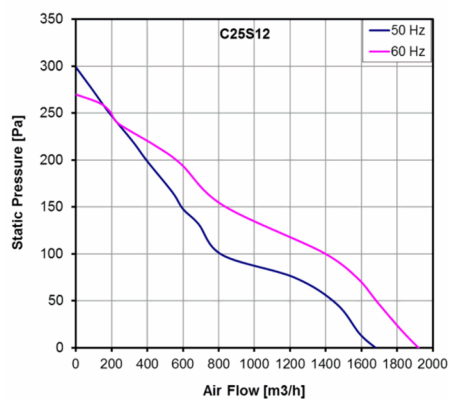

Model	Bearing	Voltage	Frequency	Rated Current	Rated Power	Max Air Flow**	Static Pressure	Noise	RPM	Approvals
		(V)	(Hz)	(A)	(W)	(m3/h)	(Pa)	[db(A)]	(rpm)	
C25S12HKBE00	Ball	115 V a.c.	50/60	1.1/0.6	107/138	1,680/1,920	299/270	64.6/67.4	2,730/3,170	CE
C25S23HKBE00	Ball	230 V a.c.	50/60	0.50/0.28	101/127	1,630/1,865	280/280	67.0/70.0	2,735/3,150	CE
C25S40HKBE00	Ball	400 V 3 ~	50/60	0.19/0.21	86/117	1,540/1,680	280/275	67.0/69.0	2,635/2,840	CE