

**"E08BL" SERIES COSTECH FANS**

Description: **EC Axial fan 80X80x38mm**

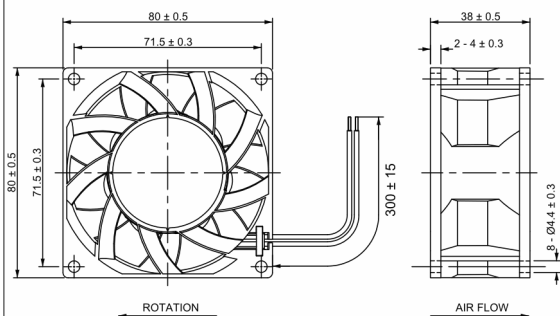

**Casing material:**

**Impeller material**

**Protection degree:**

**Fixing system:**

**Motor protection:**

**Storage temperature:**

**Rated temperature range:**

**Lifetime L10 at 25°C:**

**Electrical connection:**

**Approvals:**

**Weight:**

Thermoplastic in black color, UL 94 V-0

Thermoplastic in black color, UL 94 V-0

IP20, according to EN 60529 standard

by No 4 M4 screws

Impedance

From -40°C to +80°C

From -10°C to +70°C

50,000 h

2 leads 24 AWG UL1430

CE

0.270 kg

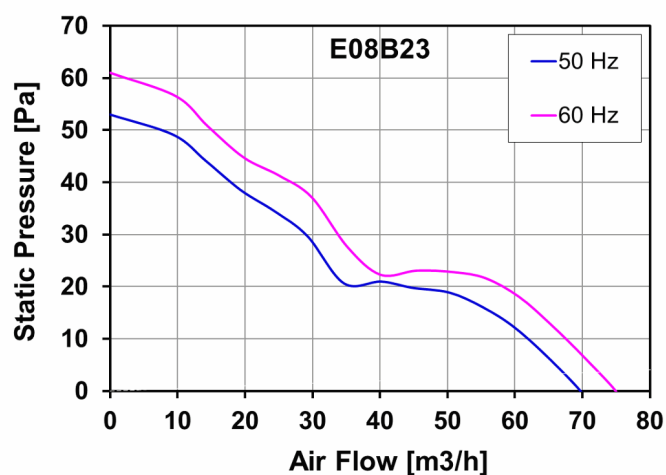
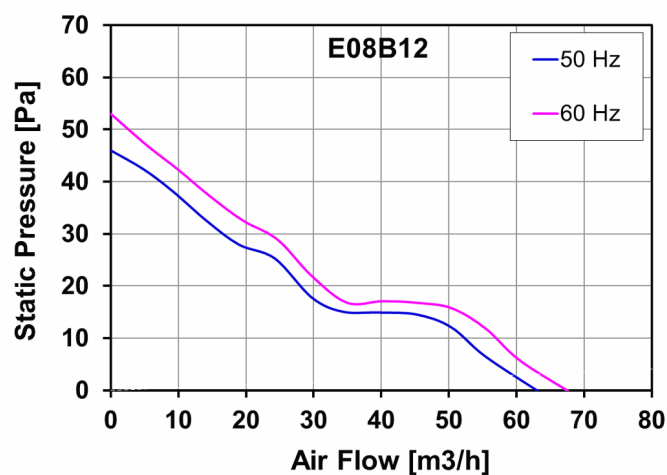

Model	Bearing	Voltage	Frequency	Rated Current	Rated Power	Max Air Flow**	Static Pressure	Noise	RPM	Approvals
		(V)	(Hz)	(A)	(W)	(m3/h)	(Pa)	[db(A)]	(rpm)	
E08B12HWBL00	Ball	115 V a.c.	50/60	0.06/0.06	5.0/5.0	64/68	46/53	35/37	2,800/3,000	CE
E08B23HWBL00	Ball	230 V a.c.	50/60	0.05/0.05	5.0/5.0	68/73	53/61	37/39	3,000/3,200	CE

## "E12BL" SERIES COSTECH FANS

Description: **EC Axial fan 120X120x38mm**

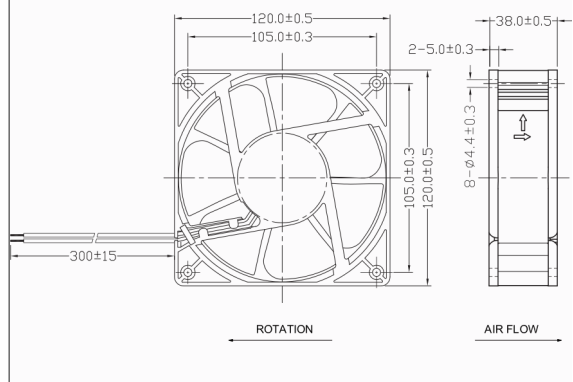

<b>Casing material:</b>	Thermoplastic in black color, UL 94 V-0
<b>Impeller material</b>	Thermoplastic in black color, UL 94 V-0
<b>Protection degree:</b>	IP20, according to EN 60529 standard
<b>Fixing system:</b>	by No 4 M4 screws
<b>Motor protection:</b>	Impedance
<b>Storage temperature:</b>	from -40°C to +75°C
<b>Rated temperature range:</b>	from -30°C to +70°C
<b>Lifetime L10 at 40°C:</b>	ball bearing 50,000 h
<b>Electrical connection:</b>	2 leads 24 AWG UL1430
<b>Approvals:</b>	CE
<b>Weight:</b>	0.270 kg

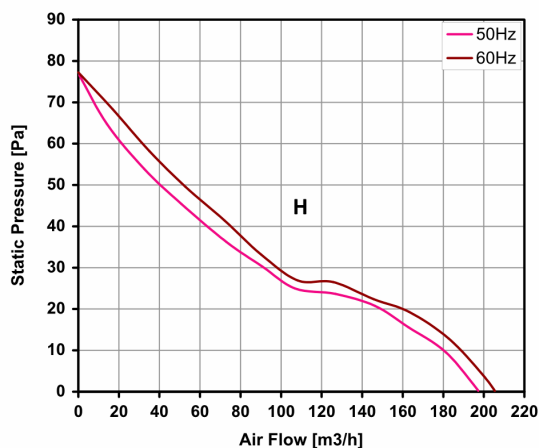
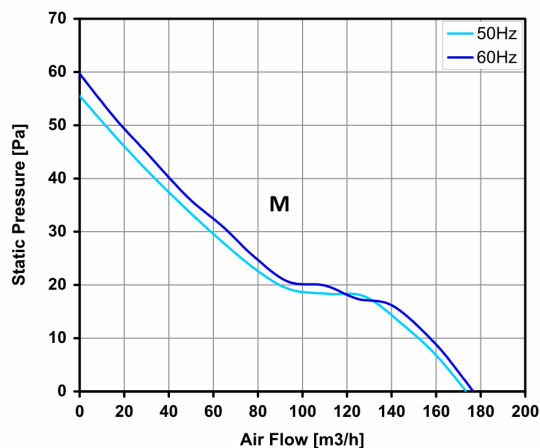
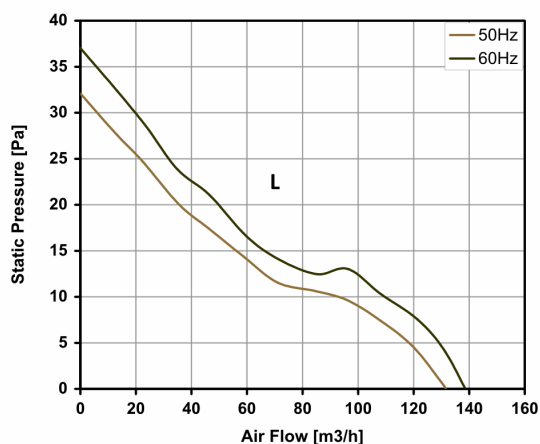

Model	Bearing	Voltage	Frequency	Rated Current	Rated Power	Max Air Flow**	Static Pressure	Noise	RPM	Approvals
		(V)	(Hz)	(A)	(W)	(m3/h)	(Pa)	[db(A)]	(rpm)	
E12B23HWBL00	Ball	230 V a.c.	50/60	0.05/0.05	6.0/6.0	198/206	79/77	45.0/46.8	3,000/3,100	CE
E12B23LWBL00	Ball	230 V a.c.	50/60	0.03/0.03	2.5/2.5	132/138	32/37	34.0/35.7	2,000/2,100	CE
E12B23MWBL00	Ball	230 V a.c.	50/60	0.04/0.04	4.0/4.0	169/176	55/58	40.0/41.8	2,500/2,700	CE

## PAR001 EC AXIAL FANS

Motor Design	: ECM
Housing	: Aluminium Die- cast
Impellor	: Thermoplastic
Bearing	: Ball Bearing
Rated Voltage	: 220 - 240 VAC
Operating Voltage	: 185 ~ 245 VAC
Dielectric Strength	: 1500 VAC for 1 minute
Insulation	: Class B
Insulation Resistance	: Above 10M Ohms at 500 VDC
Connection	: Lead Wire
Motor Protection	: Via Electronics
Operating Temperature	: -20 to +70°C for Ball Bearing
IP	: 20



## Specification

Model No.	Bearing	Voltage	Frequency	Current	Input Power	Speed ±5 %	Air Flow	Static Pressure	Noise
EC		V	Hz	A	W	RPM	CFM	mm H <sub>2</sub> O	dB(A)
PAR 001	Ball	220 / 240	50 / 60	0.07	6.5	2750	105	7.4	43

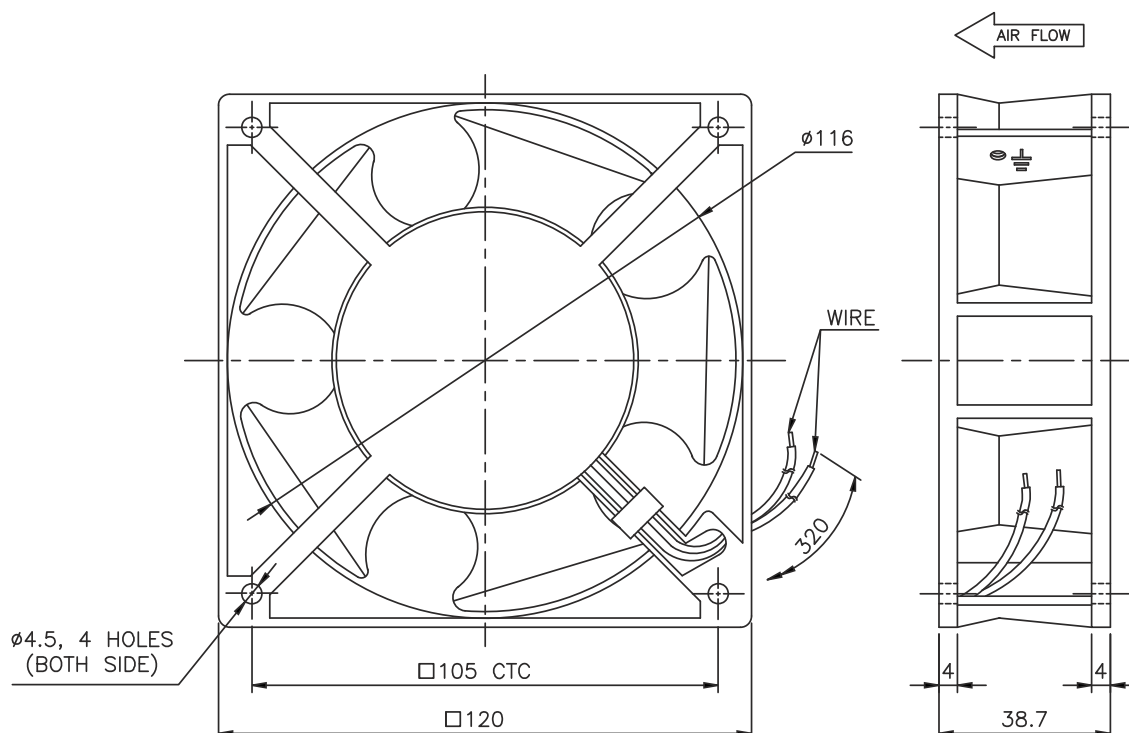

PAR001 PERFORMANCE CURVE

