

M4x40mm screw (Qty: 4)

N.D.E

D.E

Drive flange (Suitable for Metric Impellers)

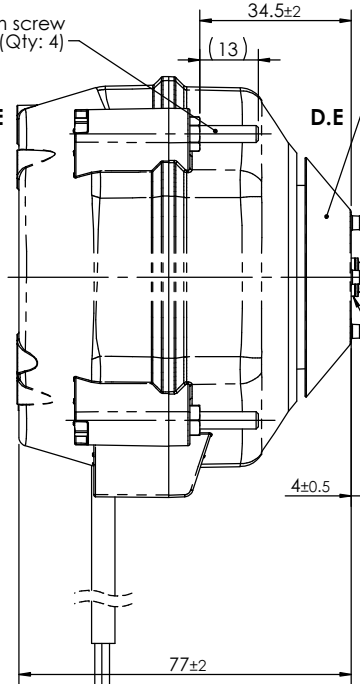

25.4 PCD

M4 flanged hex head screw with grips and flat washer

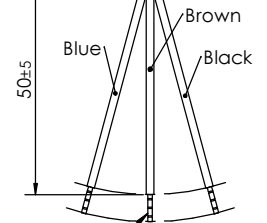
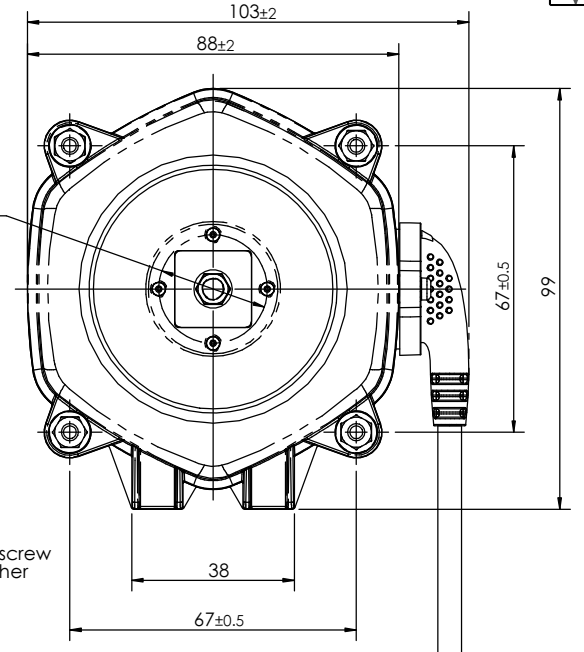

Boot lace connector, 7mm long (Qty : 3 off)

Location of Connection Diagram Label (on DE housing surface above the power cable)

Location of Batch Code Label (on DE housing surface adjacent to mounting screw)

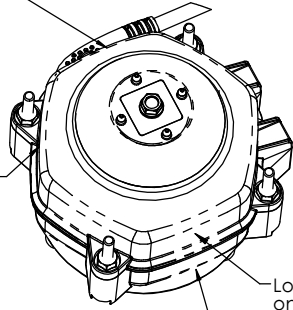

Location of A tex Label on DE housing surface

Location of Product Label on NDE housing surface

MOTOR RATING

PRODUCT CODE	Max Output Watts @ Corresponding rpm	Supply voltage, Frequency	DOR, Mode of Operation
ECR2-0C81	13 Watts @ 1800 rpm	100-240Vac, 50-60Hz	CCW-DE Continuous, Dual Speed i) Speed control 1300 rpm ii) Speed control 1400 rpm

Ex II 3 G, Ex nA IIA T4
T_{amb} -30°C to +60°C
US/UL/ExTR15.0133/00
 Do not open when energised

A tex Label

Connection Diagram

Speed Control 1300 rpm	Speed Control 1400 rpm
DOR : CCW-DE	DOR : CCW-DE
BROWN — PHASE	BROWN — PHASE
BLUE — NEUTRAL	BLUE — NEUTRAL
BLACK — NEUTRAL or N/C	BLACK — PHASE

Connection Diagram Label

Wellington[®] ECR2-0C81
 INPUT : 100-240Vac, 50-60Hz, 0.19-0.10A
 OUTPUT : 13W@1800rpm
 Dual Speed 1300/1400rpm, DOR:CCW-DE
 EP -30° to +50°C
CE
 REG: A1: E804
 -30° to +60°C

Product Label

- Note:
1. Motor rating Refer to table.
 2. Refer operating instructions for installation details
 3. Accessories to be supplied along with the motor in a bag per pallet basis.
 - Plastite Screw for rear mounting, Qty 4 per motor

N/A	1	NA	Initial Issue	22/12/2017	ASo	AHa
ZONE	ISSUE	ECN	DESCRIPTION	DATE	DRAWN	CHECKED

DO NOT SCALE OFF DRAWING Description:

Wellington[®]
 www.wdtl.com
 The information contained in this drawing is confidential. Reproduction of this document in any form is subject to explicit written permission © COPRIGHT 2004 - 2009 Wellington Drive Technologies Ltd

Product Code: Refer to table above

Orthographic Projection: Third Angle

LIFECYCLE STATE: P

Scale: Dimension Unit: NTS mm

Sheet size: A3

Sheet: 1 of 1

GENERAL TOLERANCE: LINEAR ±1mm, ANGULAR ±3°

DWG No.: ECR2-0C81